



MATERIALS OF CONSTRUCTION:
CARBON STEEL, BRASS, DUCTILE IRON

Capacity: 1 Gallons
Max Temp.: 200 F
Max Press.: 200 PSI
Weight: 16 Lbs.

20	x	x
19	x	x
18	x	x
17	x	x
16	x	x
15	x	x
14	x	x
13	x	x
12	x	x
11	x	x
10	x	x
9	x	x
8	x	x
7	x	x
6	x	x
5	x	x
4	x	x
3	x	x
2	x	x
1	x	x

#	PART	DESCRIPTION
F	x	xx/xx/xx
E	x	xx/xx/xx
D	x	xx/xx/xx
C	x	xx/xx/xx
B	x	xx/xx/xx
REV	DESCRIPTION	DATE

General Treatment Products, Inc.
PO Box 8697, Brea, CA 92822
Phone: 714) 257-9165 <http://www.gtpcompany.com>
Fax: 714) 257-9215 customerservice@gtpcompany.com

Date: 1/1/12 Scale: NTS Rev.: A

Description:
1GL FLAT BOTTOM BYPASS FEEDER

Model:
FB1

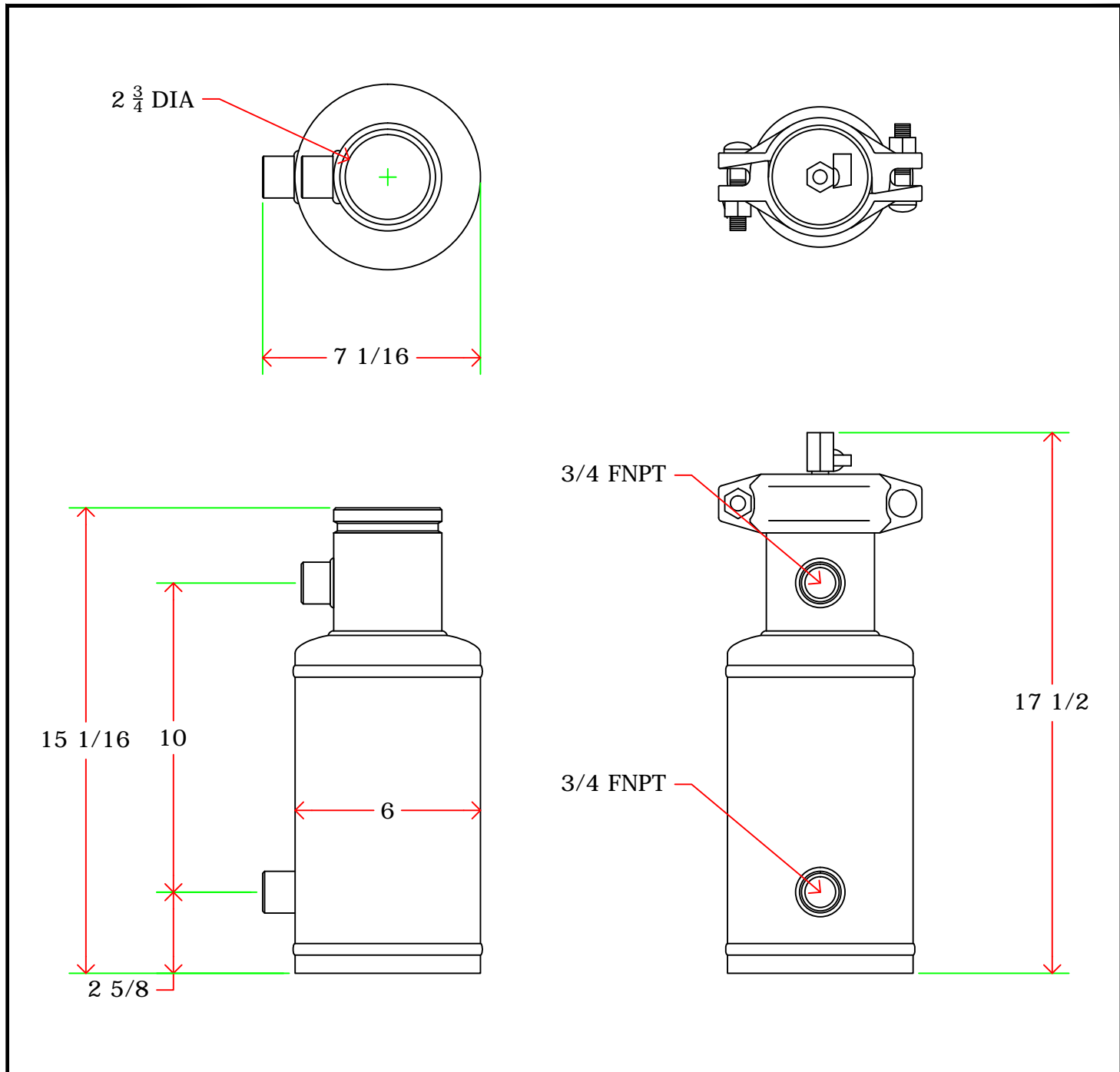

NOTICE: This drawing and its contents are for the specific use of GTP customers only. It is not to be duplicated or copied without expressed written consent of General Treatment Products, Inc. We reserve the right to modify this drawing without notice.

3 DIA

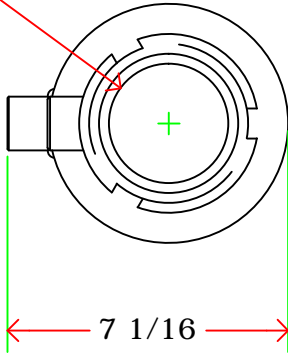

7 1/16

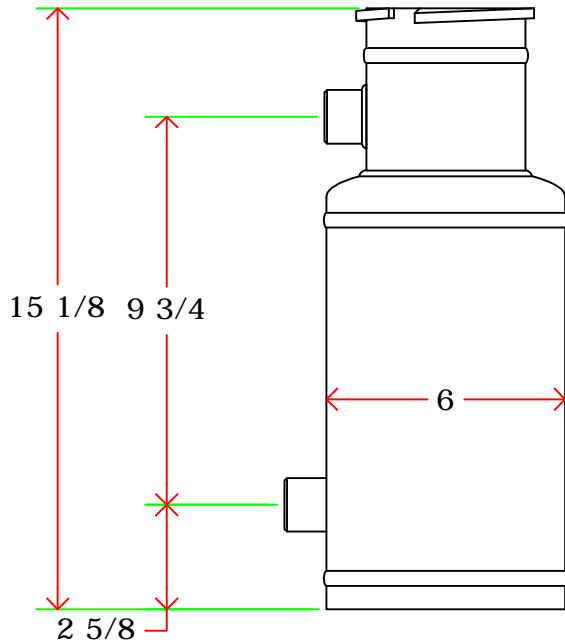
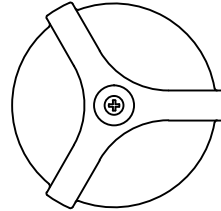

15 1/8 9 3/4

6

2 5/8

3/4 FNPT

3/4 FNPT

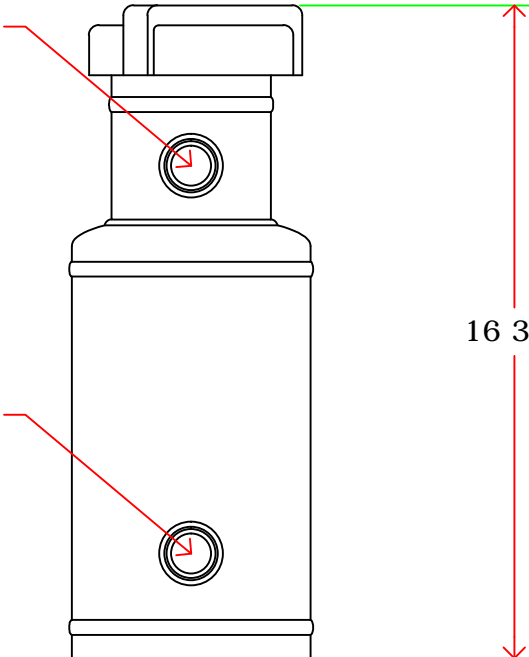

16 3/8

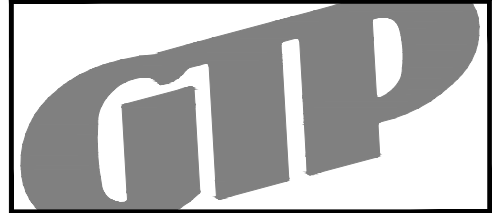

MATERIALS OF CONSTRUCTION:
CARBON STEEL, BRASS, DUCTILE IRON

Capacity: 1 Gallons
Max Temp.: 200 F
Max Press.: 200 PSI
Weight: 16 Lbs.

20	x	x
19	x	x
18	x	x
17	x	x
16	x	x
15	x	x
14	x	x
13	x	x
12	x	x
11	x	x
10	x	x
9	x	x
8	x	x
7	x	x
6	x	x
5	x	x
4	x	x
3	x	x
2	x	x
1	x	x

#	PART	DESCRIPTION
F	x	xx/xx/xx
E	x	xx/xx/xx
D	x	xx/xx/xx
C	x	xx/xx/xx
B	x	xx/xx/xx
REV	DESCRIPTION	DATE

General Treatment Products, Inc.
PO Box 8697, Brea, CA 92822
Phone: 714) 257-9165 <http://www.gtpcompany.com>
Fax: 714) 257-9215 customerservice@gtpcompany.com

Date: xx/xx/xx Scale: NTS Rev.: A

Description:
1GL FLAT BOTTOM BYPASS FEEDER

Model:
FB1/QC

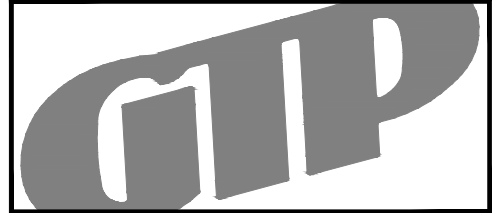
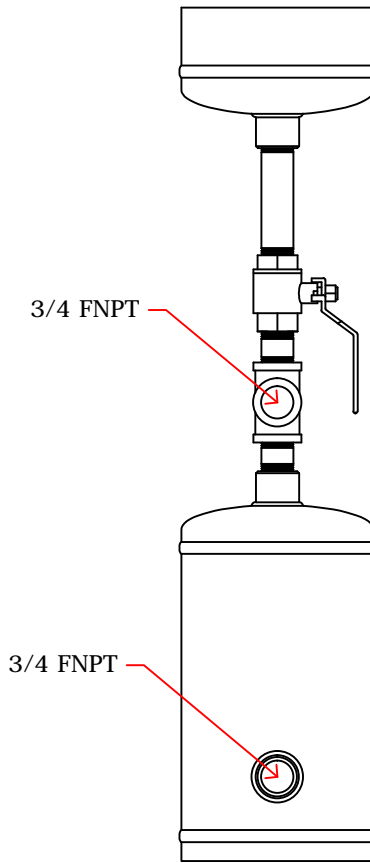
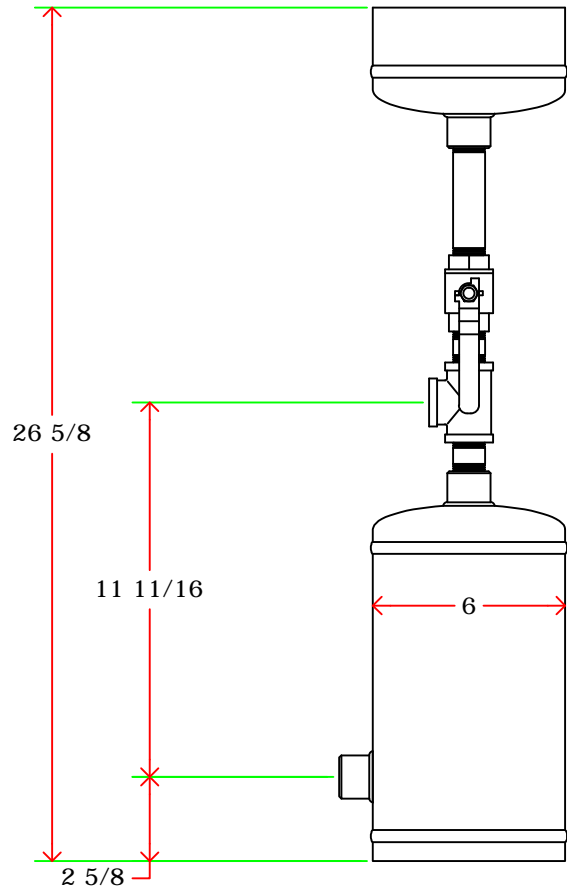
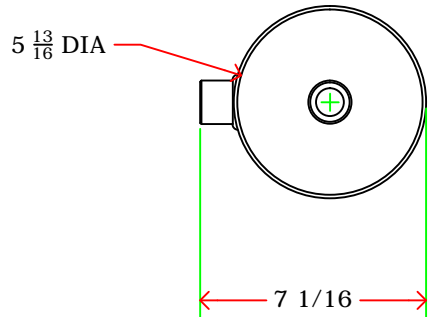

MATERIALS OF CONSTRUCTION:
CARBON STEEL, BRASS, DUCTILE IRON

Capacity: 1 Gallons
Max Temp.: 200 F
Max Press.: 300 PSI
Weight: 16 Lbs.

20	x	x
19	x	x
18	x	x
17	x	x
16	x	x
15	x	x
14	x	x
13	x	x
12	x	x
11	x	x
10	x	x
9	x	x
8	x	x
7	x	x
6	x	x
5	x	x
4	x	x
3	x	x
2	x	x
1	x	x

#	PART	DESCRIPTION
F	x	xx/xx/xx
E	x	xx/xx/xx
D	x	xx/xx/xx
C	x	xx/xx/xx
B	x	xx/xx/xx
REV	DESCRIPTION	DATE

General Treatment Products, Inc.
PO Box 8697, Brea, CA 92822
Phone: 714) 257-9165 <http://www.gtpcompany.com>
Fax: 714) 257-9215 customerservice@gtpcompany.com

Date: 1/1/12 Scale: NTS Rev.: A

Description:
1GL FLAT BOTTOM BYPASS FEEDER

Model:
FB1/HP

2 3/4 DIA

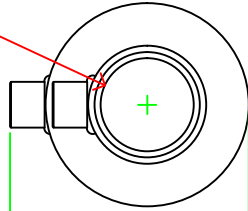

7 1/16

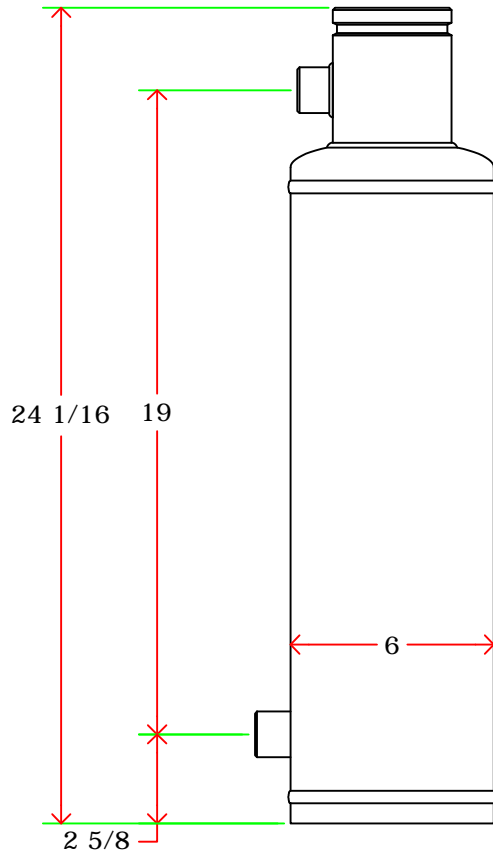
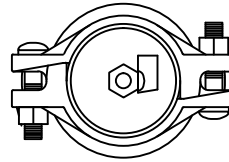

3/4 FNPT

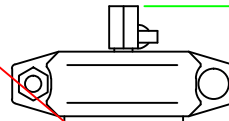

26 1/2

3/4 FNPT

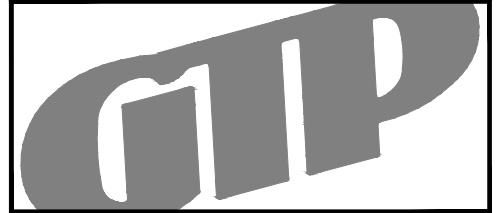
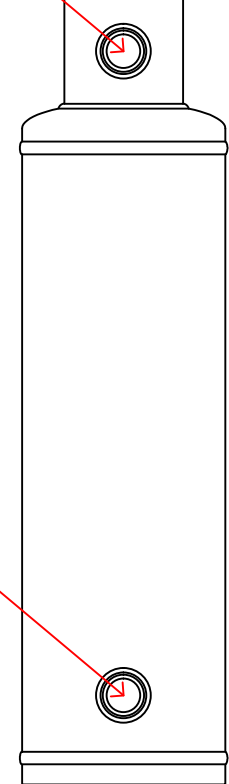

MATERIALS OF CONSTRUCTION:
CARBON STEEL, BRASS, DUCTILE IRON

Capacity: 2 Gallons
Max Temp.: 200 F
Max Press.: 300 PSI
Weight: 18 Lbs.

20	x	x
19	x	x
18	x	x
17	x	x
16	x	x
15	x	x
14	x	x
13	x	x
12	x	x
11	x	x
10	x	x
9	x	x
8	x	x
7	x	x
6	x	x
5	x	x
4	x	x
3	x	x
2	x	x
1	x	x

#	PART	DESCRIPTION
F	x	xx/xx/xx
E	x	xx/xx/xx
D	x	xx/xx/xx
C	x	xx/xx/xx
B	x	xx/xx/xx
REV	DESCRIPTION	DATE

General Treatment Products, Inc.
PO Box 8697, Brea, CA 92822
Phone: 714) 257-9165 <http://www.gtpcompany.com>
Fax: 714) 257-9215 customerservice@gtpcompany.com

Date: 1/1/12 Scale: NTS Rev.: A

Description:
2GL FLAT BOTTOM BYPASS FEEDER

Model:
FB2

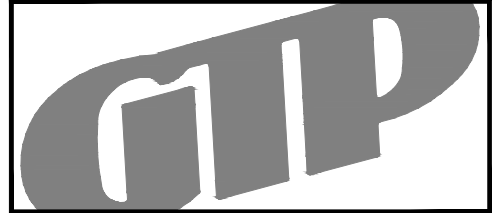
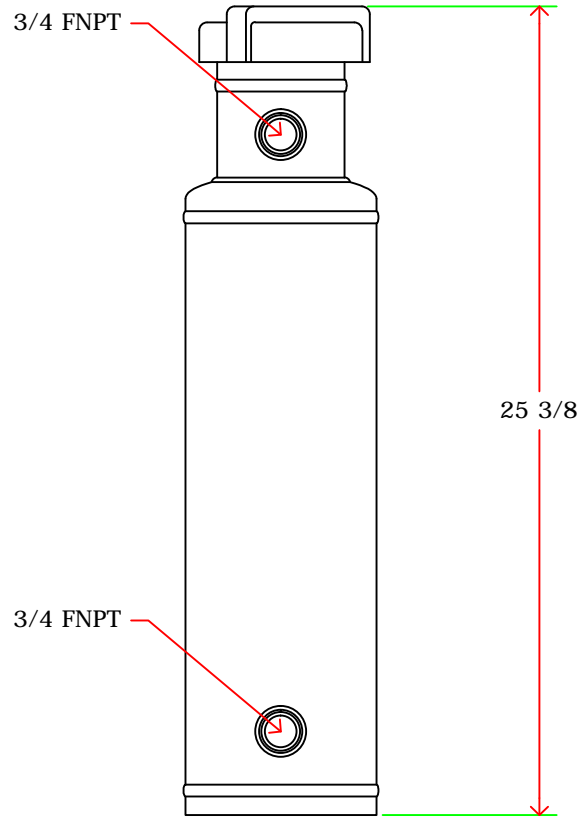
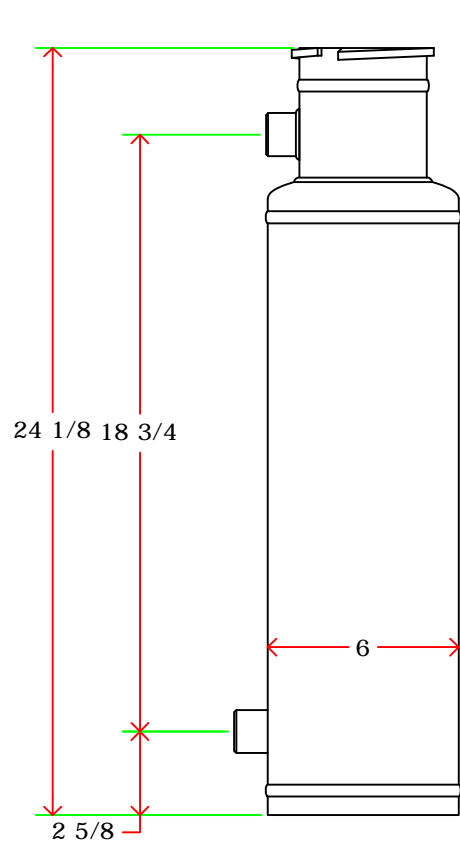
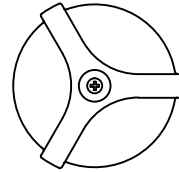
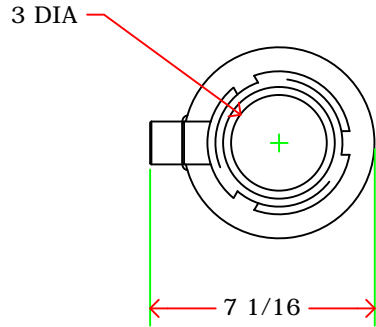

MATERIALS OF CONSTRUCTION:
CARBON STEEL, BRASS, DUCTILE IRON

Capacity: 2 Gallons
Max Temp.: 200 F
Max Press.: 200 PSI
Weight: 18 Lbs.

20	x	x
19	x	x
18	x	x
17	x	x
16	x	x
15	x	x
14	x	x
13	x	x
12	x	x
11	x	x
10	x	x
9	x	x
8	x	x
7	x	x
6	x	x
5	x	x
4	x	x
3	x	x
2	x	x
1	x	x

#	PART	DESCRIPTION
F	x	xx/xx/xx
E	x	xx/xx/xx
D	x	xx/xx/xx
C	x	xx/xx/xx
B	x	xx/xx/xx
REV	DESCRIPTION	DATE

General Treatment Products, Inc.
PO Box 8697, Brea, CA 92822
Phone: 714) 257-9165 <http://www.gtpcompany.com>
Fax: 714) 257-9215 customerservice@gtpcompany.com

Date: 1/1/12 Scale: NTS Rev.: A

Description:
2GL FLAT BOTTOM BYPASS FEEDER

Model:
FB2/QC

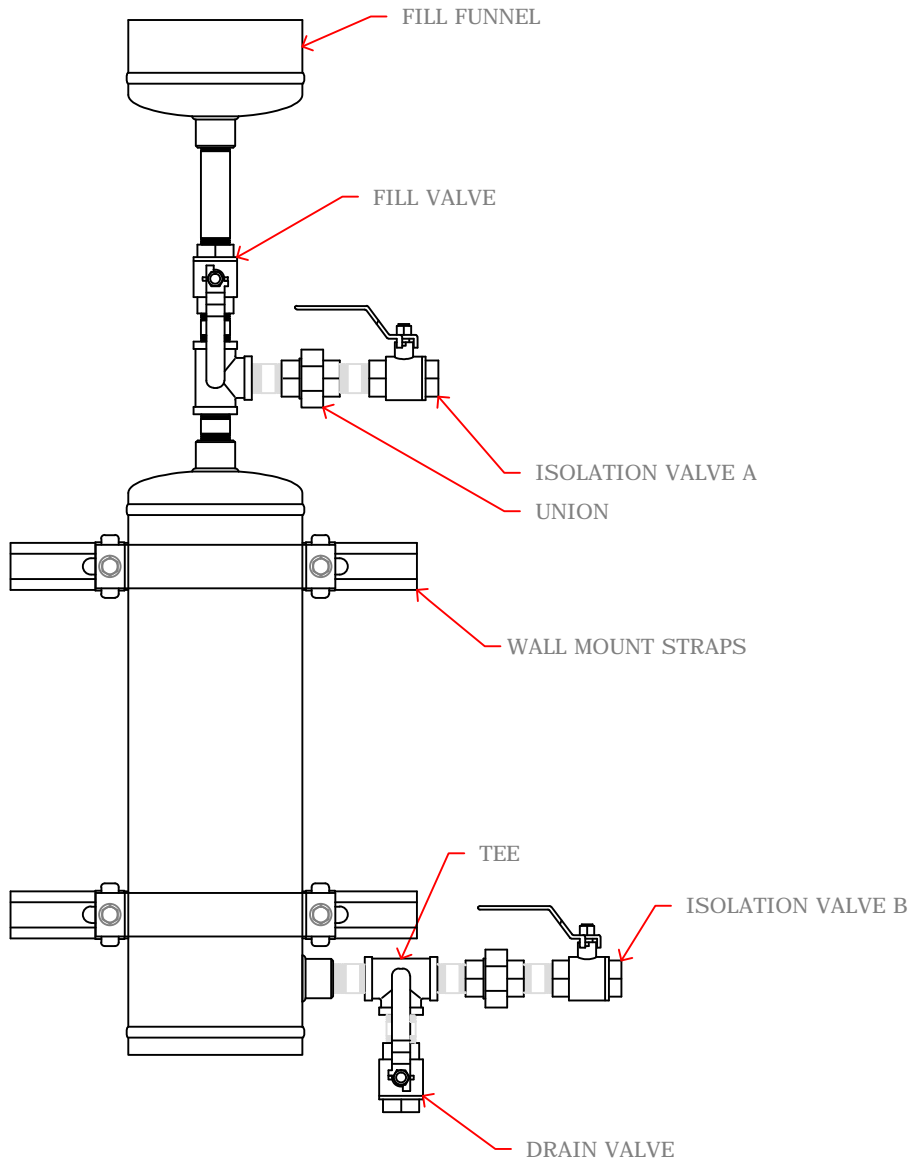
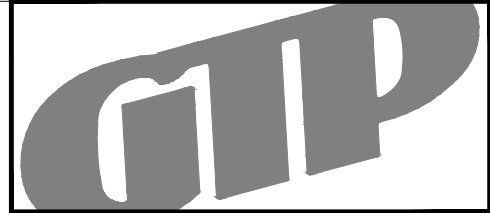

CONNECTING TO SYSTEM:

- SHOWN: FB2/HP-VPFB-STRP06

HP MODELS REQUIRE FLOW FROM BOTTOM TO TOP. VALVES SHOWN ARE A MINIMUM TO OPERATE FEEDER PROPERLY. FEEDER SHOULD BE MOUNTED SECURELY TO WALL OR FLOOR, BEING SURE ALL LOCAL BUILDING CODES HAVE BEEN FOLLOWED.

- TO CREATE FLOW, EITHER CONNECT INLET (LOWER SIDE FITTING) TO SUPPLY AND THE OUTLET (UPPER NECK FITTING) TO RETURN.

- PLUMB DRAIN VALVE TO DRAIN.

MAXIMUM PRESSURE: 300PSIG

MAXIMUM TEMPERATURE: 200F

CONSIDERATIONS:

- NEVER EXCEED VOLUME IN FLOW RATE.

EXAMPLE: 2 GALLON FEEDER - MAXIMUM 2GPM. THIS IS TO PREVENT WEAR ON FEEDER.

- BE SURE TO MOUNT SECURELY TO FLOOR OR WALL, FOLLOWING LOCAL BUILDING CODES.

- NEVER OPEN FEEDER WHILE UNDER PRESSURE. SHOULD ONLY BE SERVICED BY QUALIFIED PERSONNEL.

FILL PROCEDURE:

- 1) TO FILL THE VESSEL, CLOSE ISOLATION VALVES A & B.
- 2) OPEN DRAIN VALVE,
- 3) OPEN FILL VALVE.
- 4) CLOSE DRAIN WHEN EMPTY.
- 5) FILL FEEDER TILL LEVEL IS ABOVE FILL VALVE
- 6) CLOSE FILL VALVE
- 7) SLOWLY OPEN ISOLATION VALVES

General Treatment Products, Inc.
PO Box 8697, Brea, CA 92822
Phone: 714) 257-9165
Fax: 714) 257-9215
<http://www.gtpcompany.com>
customerservice@gtpcompany.com

Date: 1/1/12 Scale: NTS Rev.: A

Description:
FLAT BOTTOM HP FEEDER INSTALL

Model:
FB2/HP-VPFB-STRP06

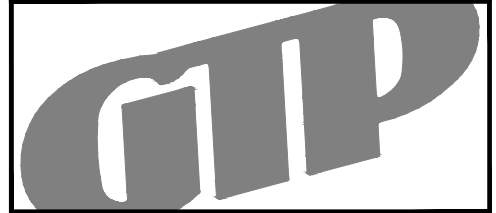
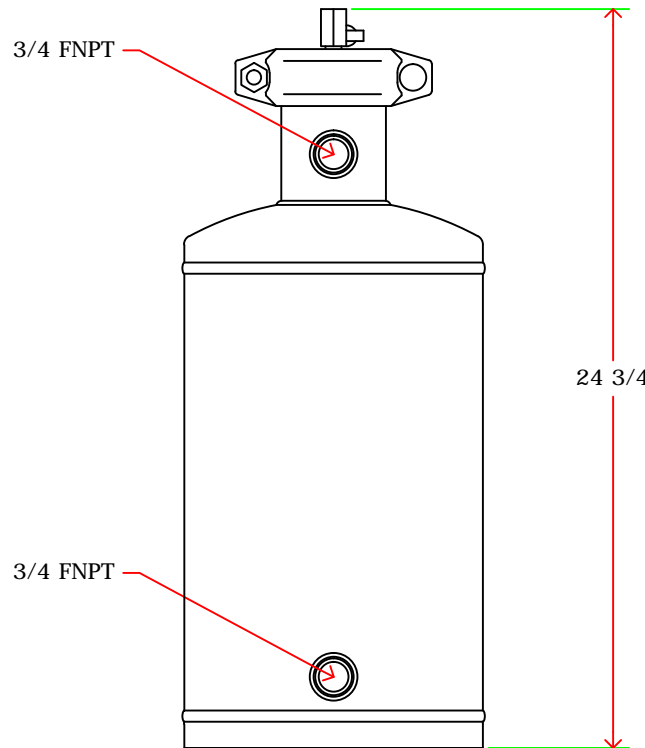
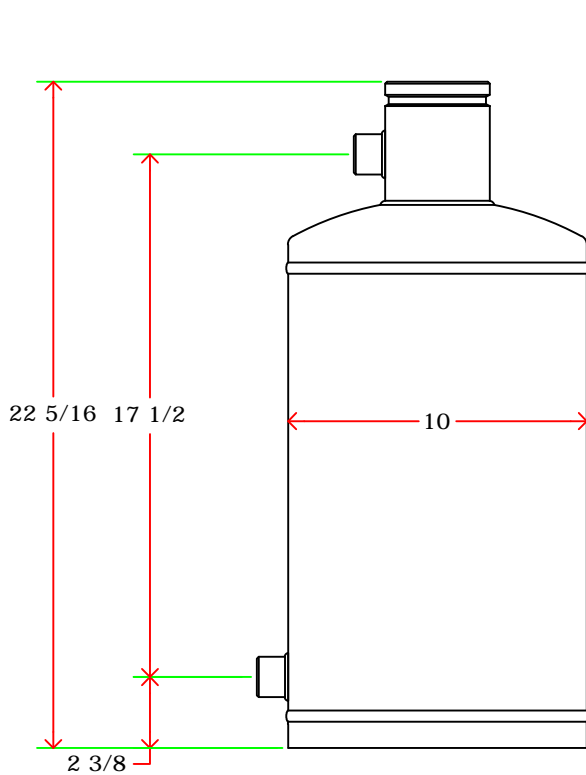
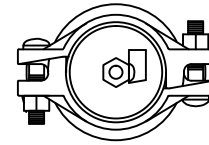
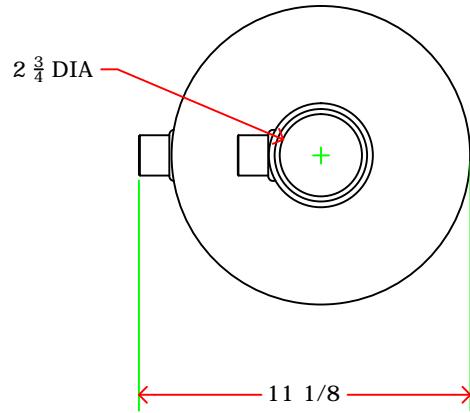

MATERIALS OF CONSTRUCTION:
CARBON STEEL, BRASS, DUCTILE IRON

Capacity: 5 Gallons
Max Temp.: 200 F
Max Press.: 200 PSI
Weight: 32 Lbs.

20	x	x
19	x	x
18	x	x
17	x	x
16	x	x
15	x	x
14	x	x
13	x	x
12	x	x
11	x	x
10	x	x
9	x	x
8	x	x
7	x	x
6	x	x
5	x	x
4	x	x
3	x	x
2	x	x
1	x	x

#	PART	DESCRIPTION
F	x	xx/xx/xx
E	x	xx/xx/xx
D	x	xx/xx/xx
C	x	xx/xx/xx
B	x	xx/xx/xx
REV	DESCRIPTION	DATE

General Treatment Products, Inc.
PO Box 8697, Brea, CA 92822
Phone: 714) 257-9165 <http://www.gtpcompany.com>
Fax: 714) 257-9215 customerservice@gtpcompany.com

Date: 1/1/12 Scale: NTS Rev.: A

Description:
5GL FLAT BOTTOM BYPASS FEEDER

Model:
FB5

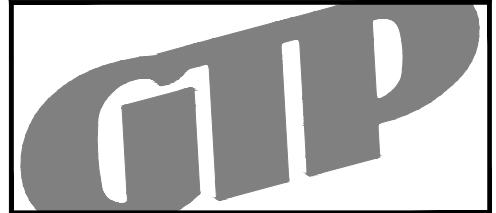
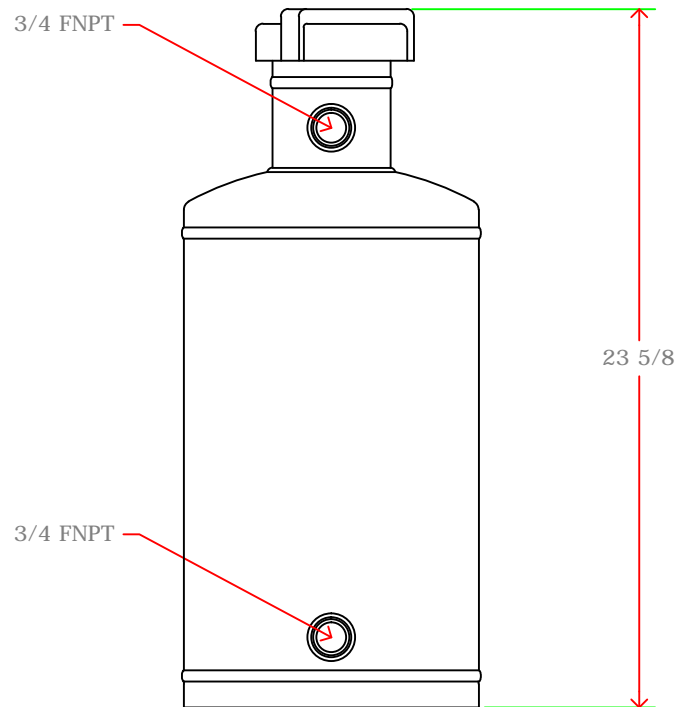
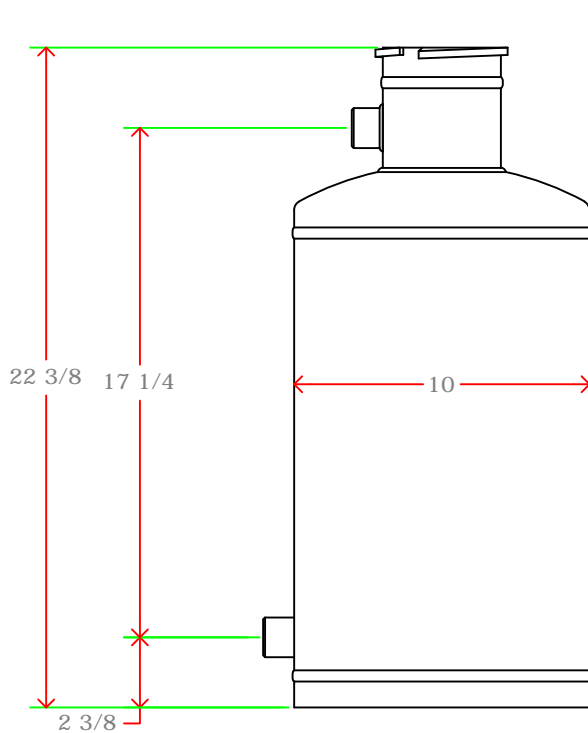
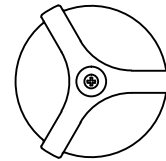
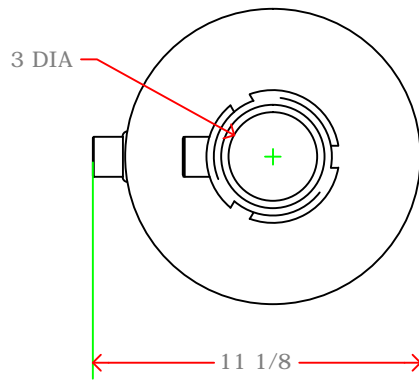

MATERIALS OF CONSTRUCTION:
CARBON STEEL, BRASS, DUCTILE IRON

Capacity: 5 Gallons
Max Temp.: 200 F
Max Press.: 300 PSI
Weight: 32 Lbs.

20	x	x
19	x	x
18	x	x
17	x	x
16	x	x
15	x	x
14	x	x
13	x	x
12	x	x
11	x	x
10	x	x
9	x	x
8	x	x
7	x	x
6	x	x
5	x	x
4	x	x
3	x	x
2	x	x
1	x	x

#	PART	DESCRIPTION
F	x	xx/xx/xx
E	x	xx/xx/xx
D	x	xx/xx/xx
C	x	xx/xx/xx
B	x	xx/xx/xx
REV	DESCRIPTION	DATE

General Treatment Products, Inc.
PO Box 8697, Brea, CA 92822
Phone: 714) 257-9165 <http://www.gtpcompany.com>
Fax: 714) 257-9215 customerservice@gtpcompany.com

Date: 1/1/12 Scale: NTS Rev.: A

Description:
5GL FLAT BOTTOM BYPASS FEEDER

Model:
FB5/QC

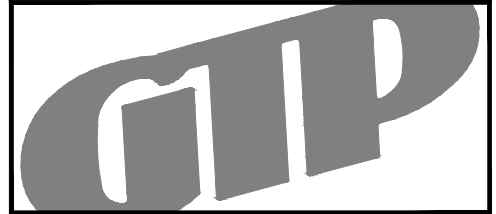
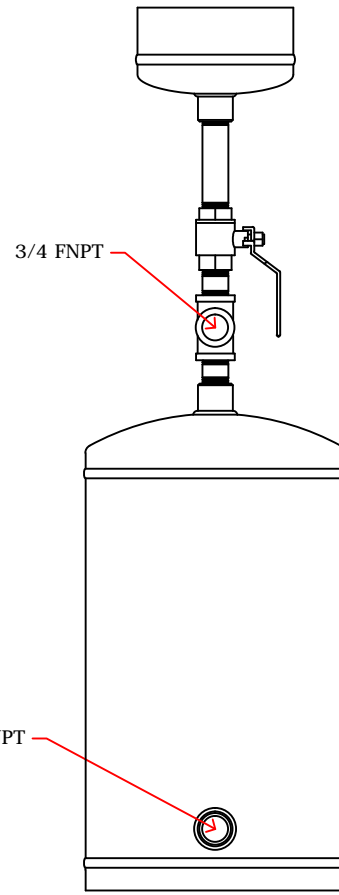
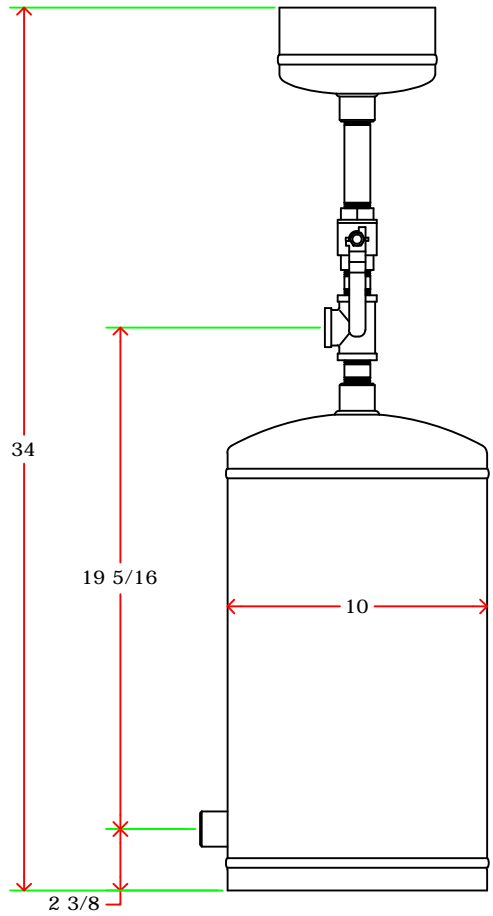
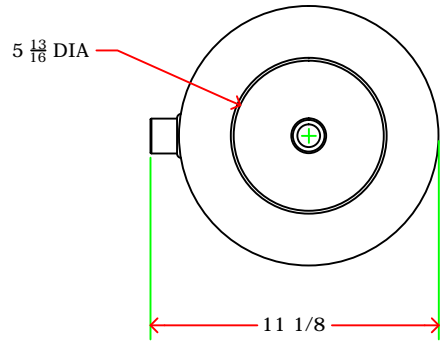

MATERIALS OF CONSTRUCTION:
CARBON STEEL, BRASS, DUCTILE IRON

Capacity: 5 Gallons
Max Temp.: 200 F
Max Press.: 300 PSI
Weight: 32 Lbs.

20	x	x
19	x	x
18	x	x
17	x	x
16	x	x
15	x	x
14	x	x
13	x	x
12	x	x
11	x	x
10	x	x
9	x	x
8	x	x
7	x	x
6	x	x
5	x	x
4	x	x
3	x	x
2	x	x
1	x	x

#	PART	DESCRIPTION
F	x	xx/xx/xx
E	x	xx/xx/xx
D	x	xx/xx/xx
C	x	xx/xx/xx
B	x	xx/xx/xx
REV	DESCRIPTION	DATE

General Treatment Products, Inc.
PO Box 8697, Brea, CA 92822
Phone: 714) 257-9165 <http://www.gtpcompany.com>
Fax: 714) 257-9215 customerservice@gtpcompany.com

Date: 1/1/12 Scale: NTS Rev.: A

Description:
5GL FLAT BOTTOM BYPASS FEEDER

Model:
FB5/HP

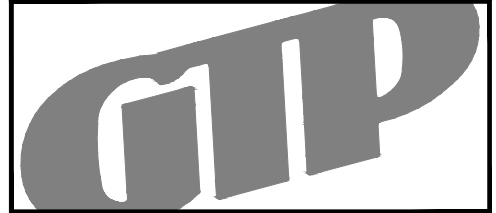
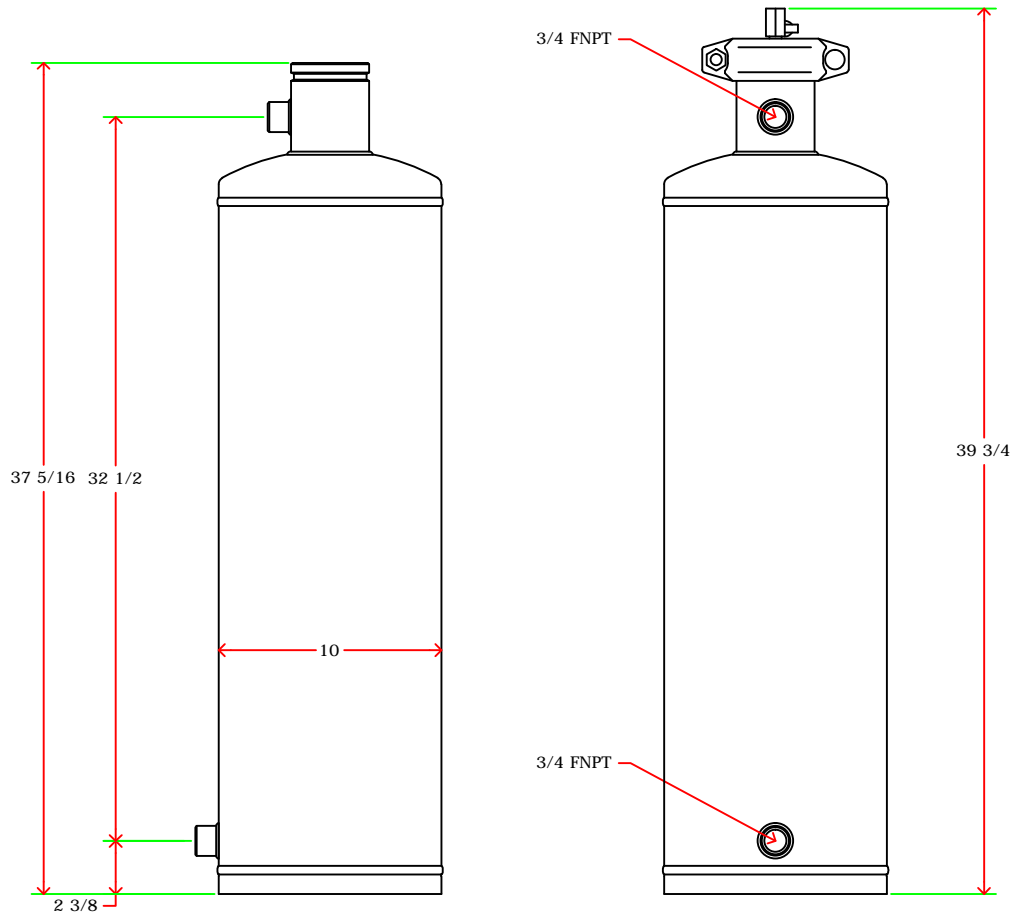
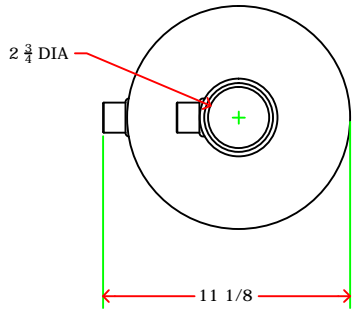

MATERIALS OF CONSTRUCTION:
CARBON STEEL, BRASS, DUCTILE IRON

Capacity: 10 Gallons
Max Temp.: 200 F
Max Press.: 300 PSI
Weight: 49 Lbs.

20	x	x
19	x	x
18	x	x
17	x	x
16	x	x
15	x	x
14	x	x
13	x	x
12	x	x
11	x	x
10	x	x
9	x	x
8	x	x
7	x	x
6	x	x
5	x	x
4	x	x
3	x	x
2	x	x
1	x	x

#	PART	DESCRIPTION
F	x	xx/xx/xx
E	x	xx/xx/xx
D	x	xx/xx/xx
C	x	xx/xx/xx
B	x	xx/xx/xx
REV	DESCRIPTION	DATE

General Treatment Products, Inc.
PO Box 8697, Brea, CA 92822
Phone: 714) 257-9165 <http://www.gtpcompany.com>
Fax: 714) 257-9215 customerservice@gtpcompany.com

Date: 1/1/12 Scale: NTS Rev.: A

Description:
10GL FLAT BOTTOM BYPASS FEEDER

Model:
FB10

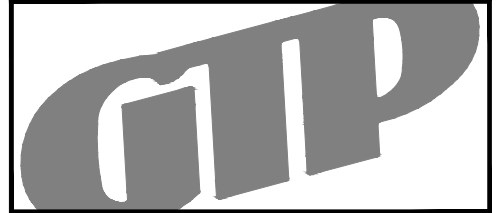
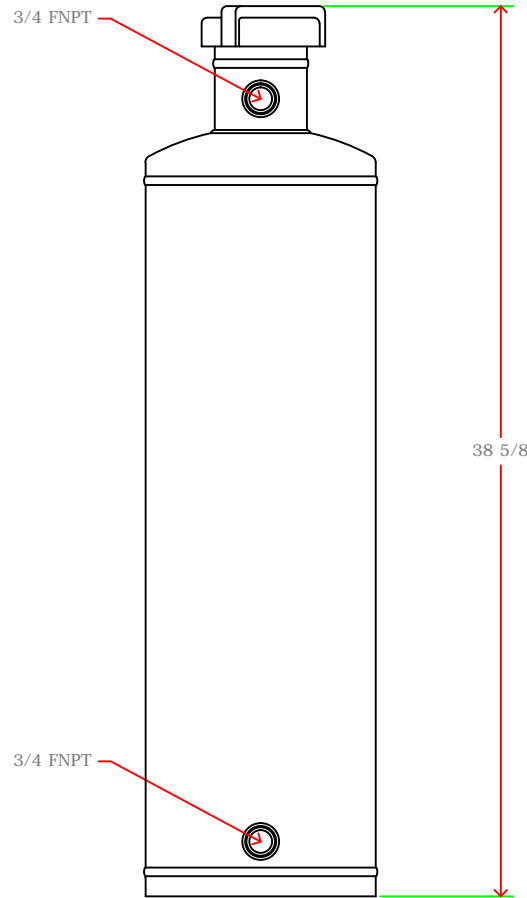
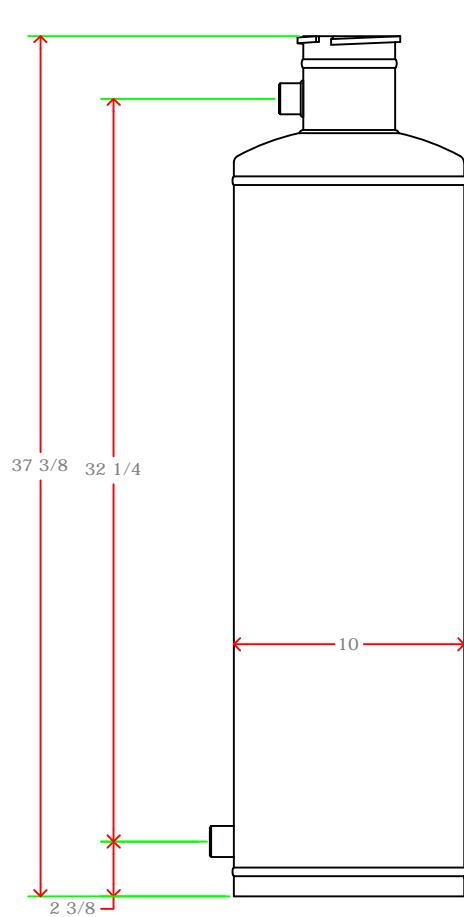
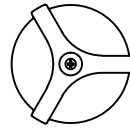
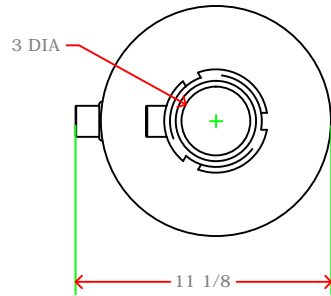

MATERIALS OF CONSTRUCTION:
CARBON STEEL, BRASS, DUCTILE IRON

Capacity: 10 Gallons
Max Temp.: 200 F
Max Press.: 200 PSI
Weight: 49 Lbs.

20	x	x
19	x	x
18	x	x
17	x	x
16	x	x
15	x	x
14	x	x
13	x	x
12	x	x
11	x	x
10	x	x
9	x	x
8	x	x
7	x	x
6	x	x
5	x	x
4	x	x
3	x	x
2	x	x
1	x	x

#	PART	DESCRIPTION
F	x	xx/xx/xx
E	x	xx/xx/xx
D	x	xx/xx/xx
C	x	xx/xx/xx
B	x	xx/xx/xx
REV	DESCRIPTION	DATE

General Treatment Products, Inc.
PO Box 8697, Brea, CA 92822
Phone: 714) 257-9165 <http://www.gtpcompany.com>
Fax: 714) 257-9215 customerservice@gtpcompany.com

Date: 1/1/12 Scale: NTS Rev.: A

Description:
10GL FLAT BOTTOM BYPASS FEEDER

Model:
FB10/QC

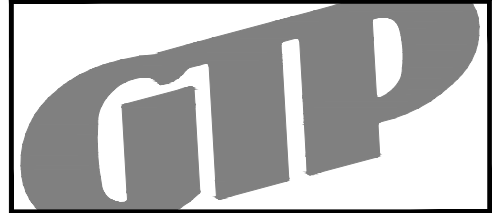
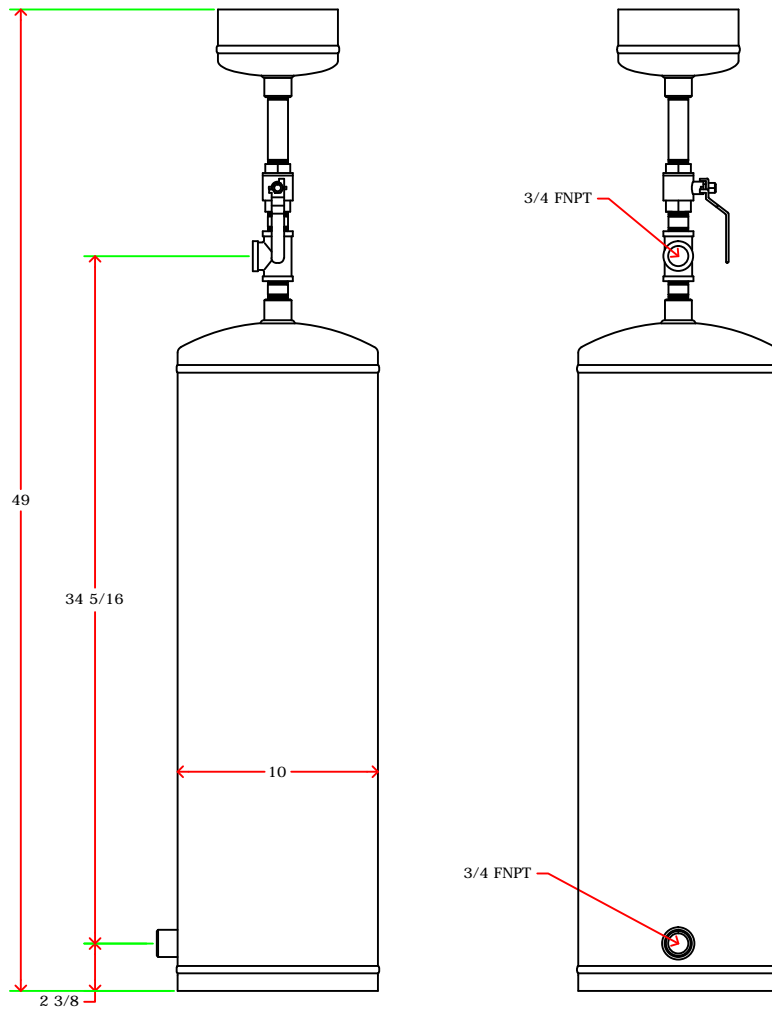
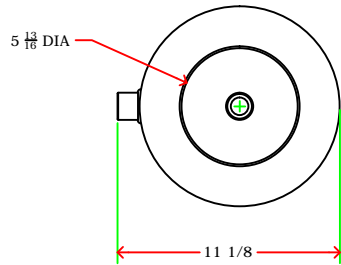

MATERIALS OF CONSTRUCTION:
CARBON STEEL, BRASS, DUCTILE IRON

Capacity: 10 Gallons
Max Temp.: 200 F
Max Press.: 300 PSI
Weight: 49 Lbs.

20	x	x
19	x	x
18	x	x
17	x	x
16	x	x
15	x	x
14	x	x
13	x	x
12	x	x
11	x	x
10	x	x
9	x	x
8	x	x
7	x	x
6	x	x
5	x	x
4	x	x
3	x	x
2	x	x
1	x	x

#	PART	DESCRIPTION
F	x	xx/xx/xx
E	x	xx/xx/xx
D	x	xx/xx/xx
C	x	xx/xx/xx
B	x	xx/xx/xx
REV	DESCRIPTION	DATE

General Treatment Products, Inc.
PO Box 8697, Brea, CA 92822
Phone: 714) 257-9165 <http://www.gtpcompany.com>
Fax: 714) 257-9215 customerservice@gtpcompany.com

Date: 1/1/12 Scale: NTS Rev.: A

Description:
10GL FLAT BOTTOM BYPASS FEEDER

Model:
FB10/HP

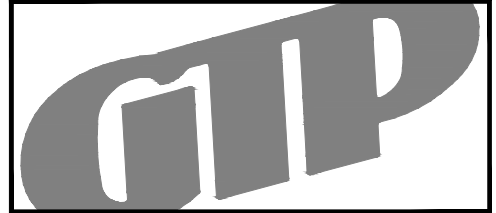
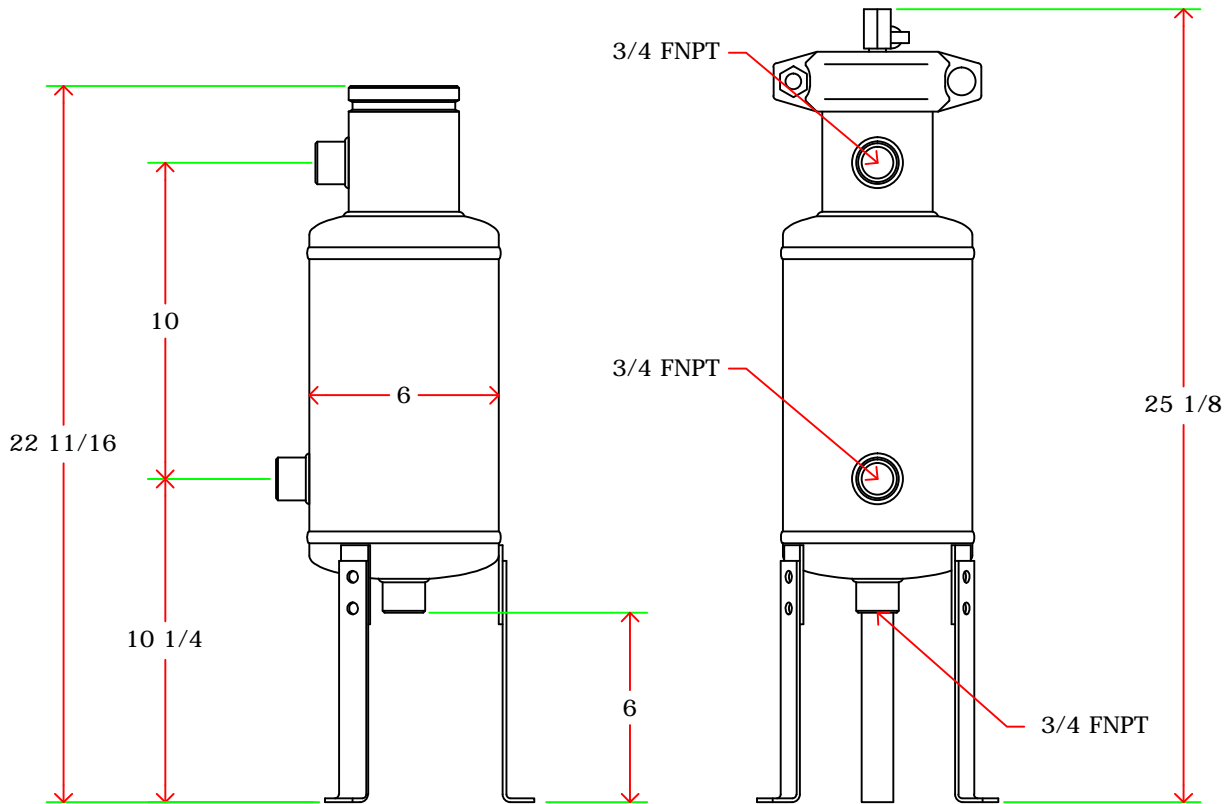
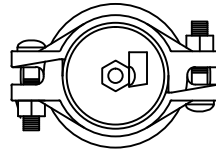
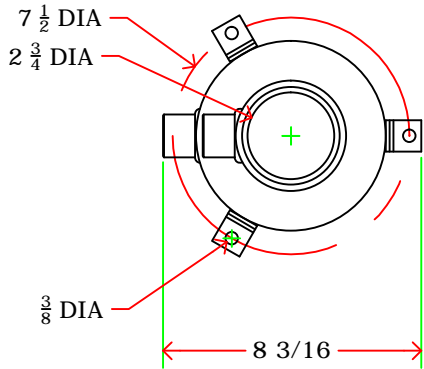

MATERIALS OF CONSTRUCTION:
CARBON STEEL, BRASS, DUCTILE IRON

Capacity: 1 Gallons
Max Temp.: 200 F
Max Press.: 300 PSI
Weight: 17 Lbs.

20	x	x
19	x	x
18	x	x
17	x	x
16	x	x
15	x	x
14	x	x
13	x	x
12	x	x
11	x	x
10	x	x
9	x	x
8	x	x
7	x	x
6	x	x
5	x	x
4	x	x
3	x	x
2	x	x
1	x	x

#	PART	DESCRIPTION
F	x	xx/xx/xx
E	x	xx/xx/xx
D	x	xx/xx/xx
C	x	xx/xx/xx
B	x	xx/xx/xx
REV	DESCRIPTION	DATE

General Treatment Products, Inc.
PO Box 8697, Brea, CA 92822
Phone: 714) 257-9165
Fax: 714) 257-9215
<http://www.gtpcompany.com>
customerservice@gtpcompany.com

Date: 1/1/12 Scale: NTS Rev.: A

Description:
1GL DOME BOTTOM BYPASS FEEDER

Model:
DB1

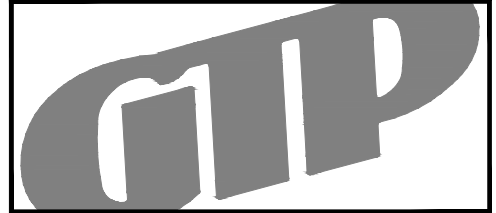
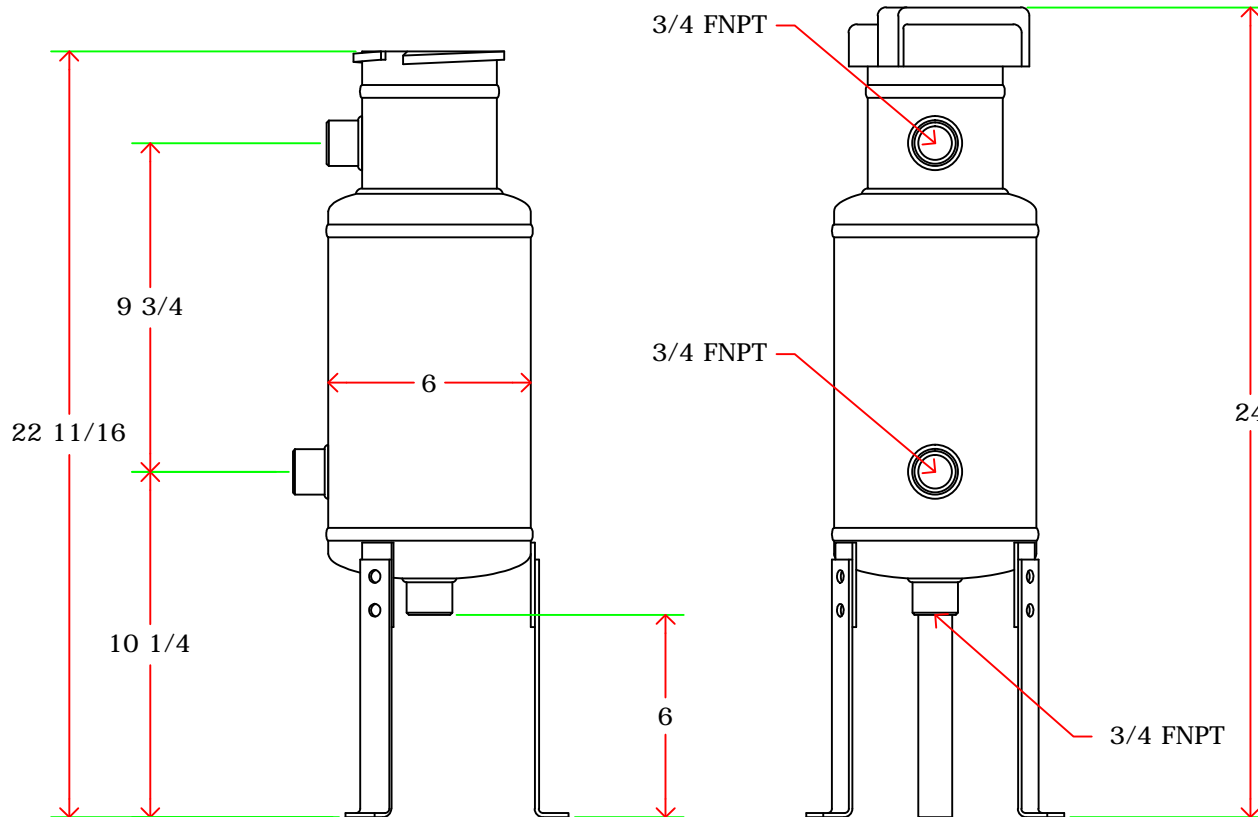
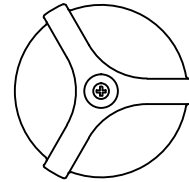
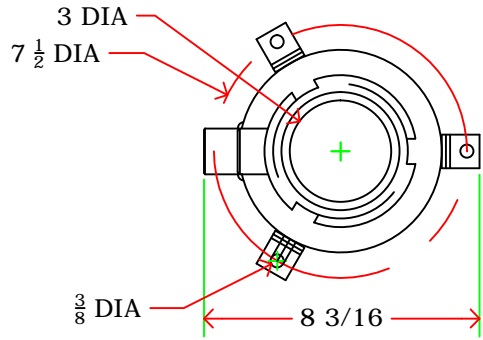

MATERIALS OF CONSTRUCTION:
CARBON STEEL, BRASS, DUCTILE IRON

Capacity: 1 Gallons
Max Temp.: 200 F
Max Press.: 200 PSI
Weight: 17 Lbs.

20	x	x
19	x	x
18	x	x
17	x	x
16	x	x
15	x	x
14	x	x
13	x	x
12	x	x
11	x	x
10	x	x
9	x	x
8	x	x
7	x	x
6	x	x
5	x	x
4	x	x
3	x	x
2	x	x
1	x	x

#	PART	DESCRIPTION
F	x	xx/xx/xx
E	x	xx/xx/xx
D	x	xx/xx/xx
C	x	xx/xx/xx
B	x	xx/xx/xx
REV	DESCRIPTION	DATE

General Treatment Products, Inc.
PO Box 8697, Brea, CA 92822
Phone: 714) 257-9165
Fax: 714) 257-9215
<http://www.gtpcompany.com>
customerservice@gtpcompany.com

Date: 1/1/12 Scale: NTS Rev.: A

Description:
1GL DOME BOTTOM BYPASS FEEDER

Model:
DB1/QC

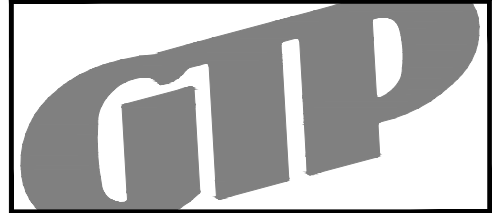
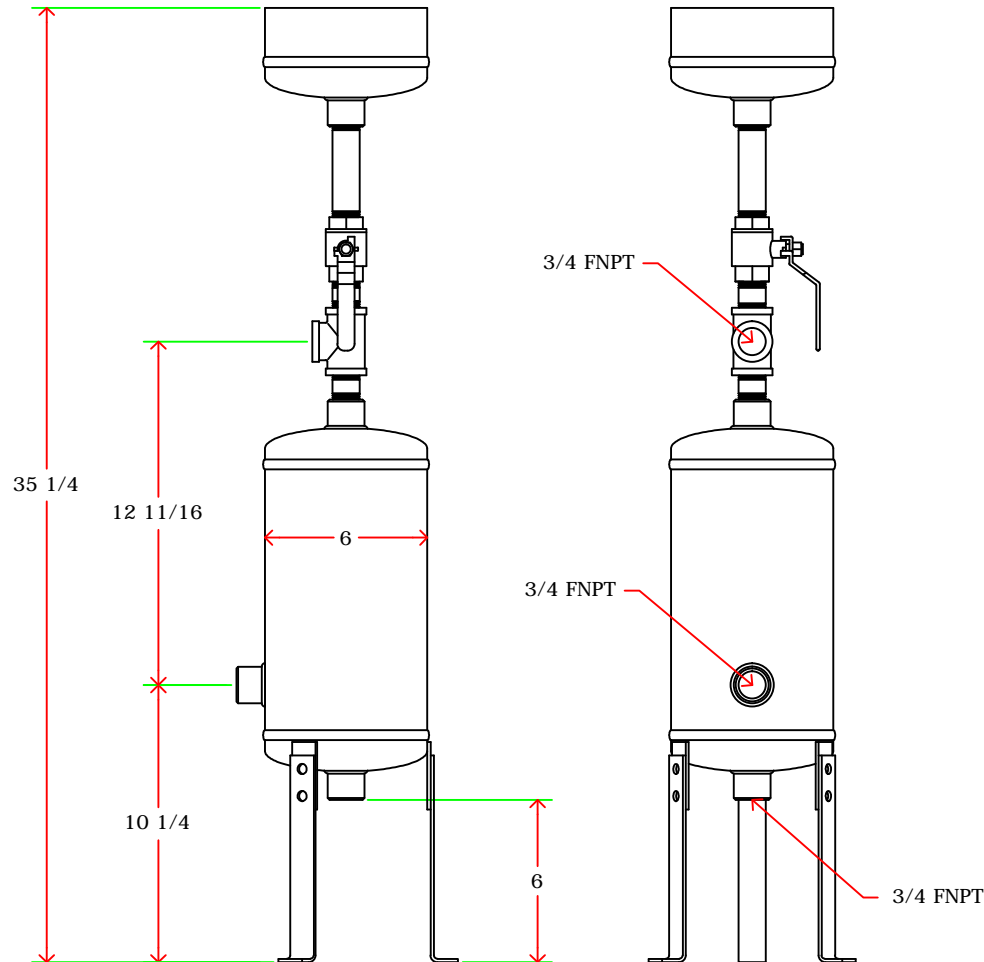
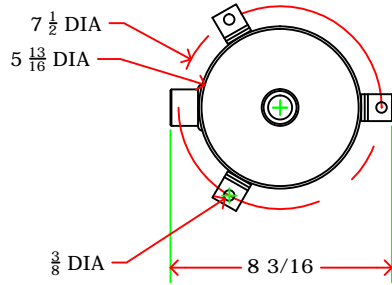

MATERIALS OF CONSTRUCTION:
CARBON STEEL, BRASS, DUCTILE IRON

Capacity: 1 Gallons
Max Temp.: 200 F
Max Press.: 300 PSI
Weight: 17 Lbs.

20	x	x
19	x	x
18	x	x
17	x	x
16	x	x
15	x	x
14	x	x
13	x	x
12	x	x
11	x	x
10	x	x
9	x	x
8	x	x
7	x	x
6	x	x
5	x	x
4	x	x
3	x	x
2	x	x
1	x	x

#	PART	DESCRIPTION
F	x	xx/xx/xx
E	x	xx/xx/xx
D	x	xx/xx/xx
C	x	xx/xx/xx
B	x	xx/xx/xx
REV	DESCRIPTION	DATE

General Treatment Products, Inc.
PO Box 8697, Brea, CA 92822
Phone: 714) 257-9165 <http://www.gtpcompany.com>
Fax: 714) 257-9215 customerservice@gtpcompany.com

Date: 1/1/12 Scale: NTS Rev.: A

Description:
1GL DOME BOTTOM BYPASS FEEDER

Model:
DB1/HP

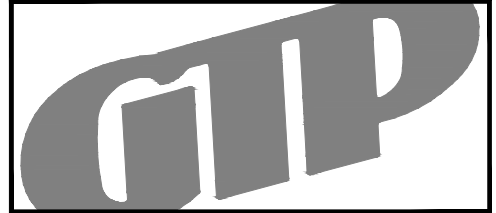
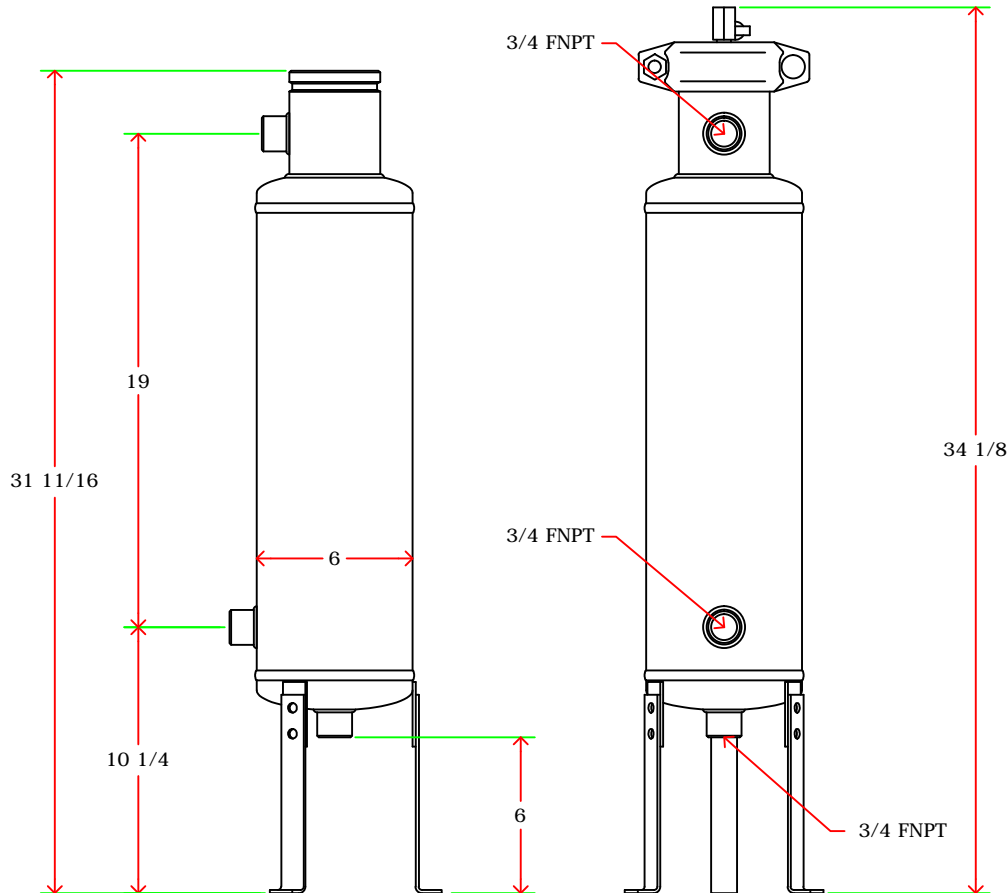
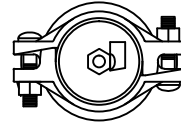
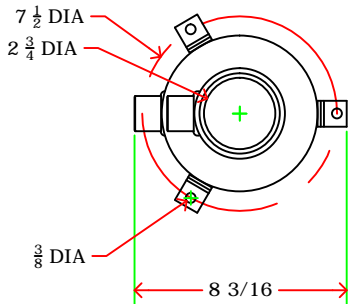

MATERIALS OF CONSTRUCTION:
CARBON STEEL, BRASS, DUCTILE IRON

Capacity: 2 Gallons
Max Temp.: 200 F
Max Press.: 300 PSI
Weight: 22 Lbs.

20	x	x
19	x	x
18	x	x
17	x	x
16	x	x
15	x	x
14	x	x
13	x	x
12	x	x
11	x	x
10	x	x
9	x	x
8	x	x
7	x	x
6	x	x
5	x	x
4	x	x
3	x	x
2	x	x
1	x	x

#	PART	DESCRIPTION
F	x	xx/xx/xx
E	x	xx/xx/xx
D	x	xx/xx/xx
C	x	xx/xx/xx
B	x	xx/xx/xx
REV	DESCRIPTION	DATE

General Treatment Products, Inc.
PO Box 8697, Brea, CA 92822
Phone: 714) 257-9165
Fax: 714) 257-9215
<http://www.gtpcompany.com>
customerservice@gtpcompany.com

Date: 1/1/12 Scale: NTS Rev.: A

Description:
2GL DOME BOTTOM BYPASS FEEDER

Model:
DB2

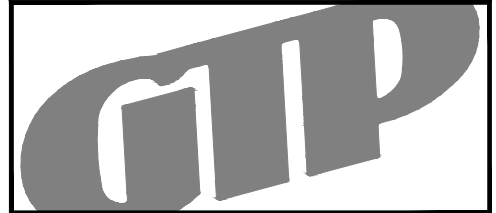
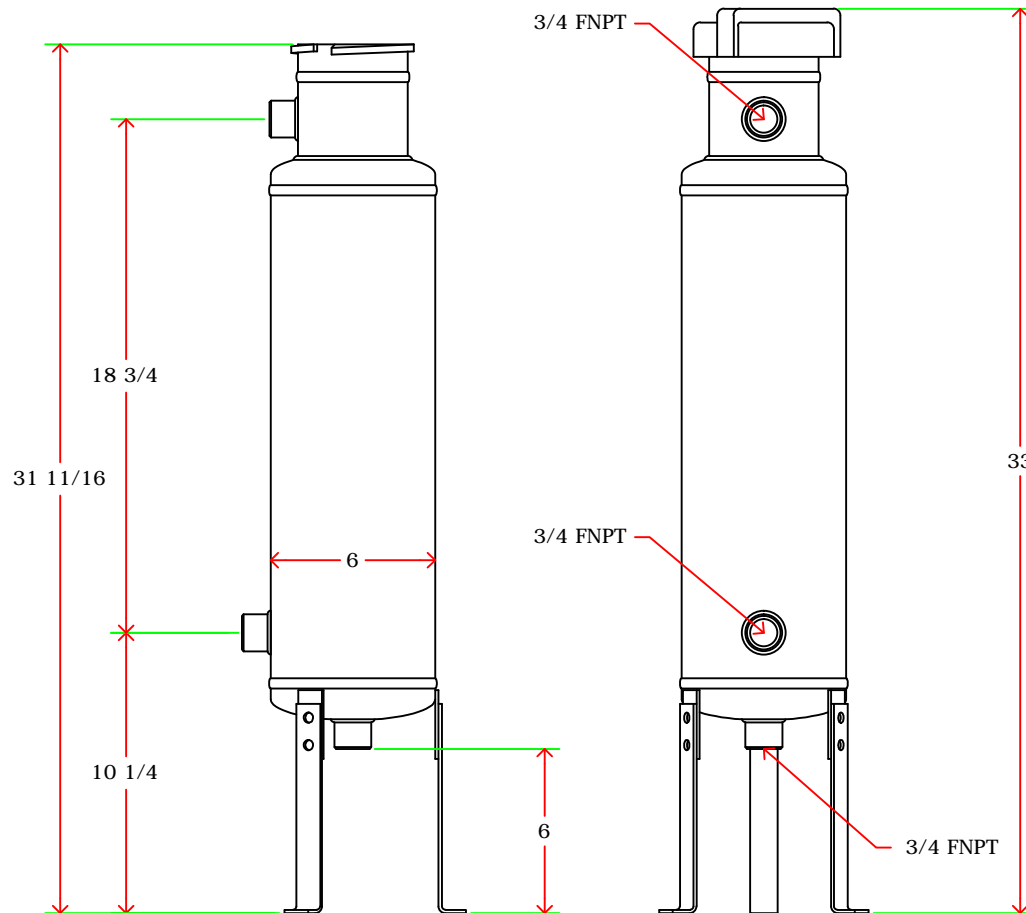
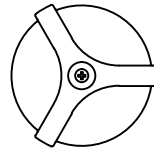
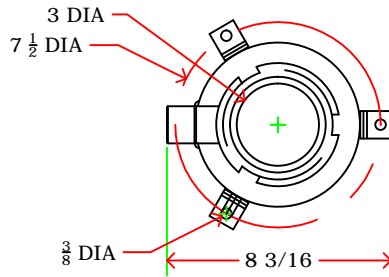

MATERIALS OF CONSTRUCTION:
CARBON STEEL, BRASS, DUCTILE IRON

Capacity: 2 Gallons
Max Temp.: 200 F
Max Press.: 200 PSI
Weight: 22 Lbs.

20	x	x
19	x	x
18	x	x
17	x	x
16	x	x
15	x	x
14	x	x
13	x	x
12	x	x
11	x	x
10	x	x
9	x	x
8	x	x
7	x	x
6	x	x
5	x	x
4	x	x
3	x	x
2	x	x
1	x	x

#	PART	DESCRIPTION
F	x	xx/xx/xx
E	x	xx/xx/xx
D	x	xx/xx/xx
C	x	xx/xx/xx
B	x	xx/xx/xx
REV	DESCRIPTION	DATE

General Treatment Products, Inc.
PO Box 8697, Brea, CA 92822
Phone: 714) 257-9165
Fax: 714) 257-9215
<http://www.gtpcompany.com>
customerservice@gtpcompany.com

Date: 1/1/12 Scale: NTS Rev.: A

Description:
2GL DOME BOTTOM BYPASS FEEDER

Model:
DB2/QC

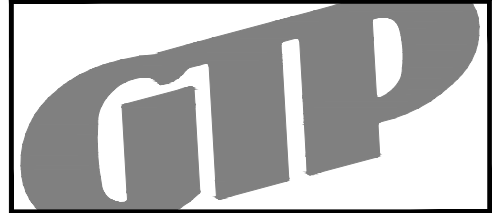
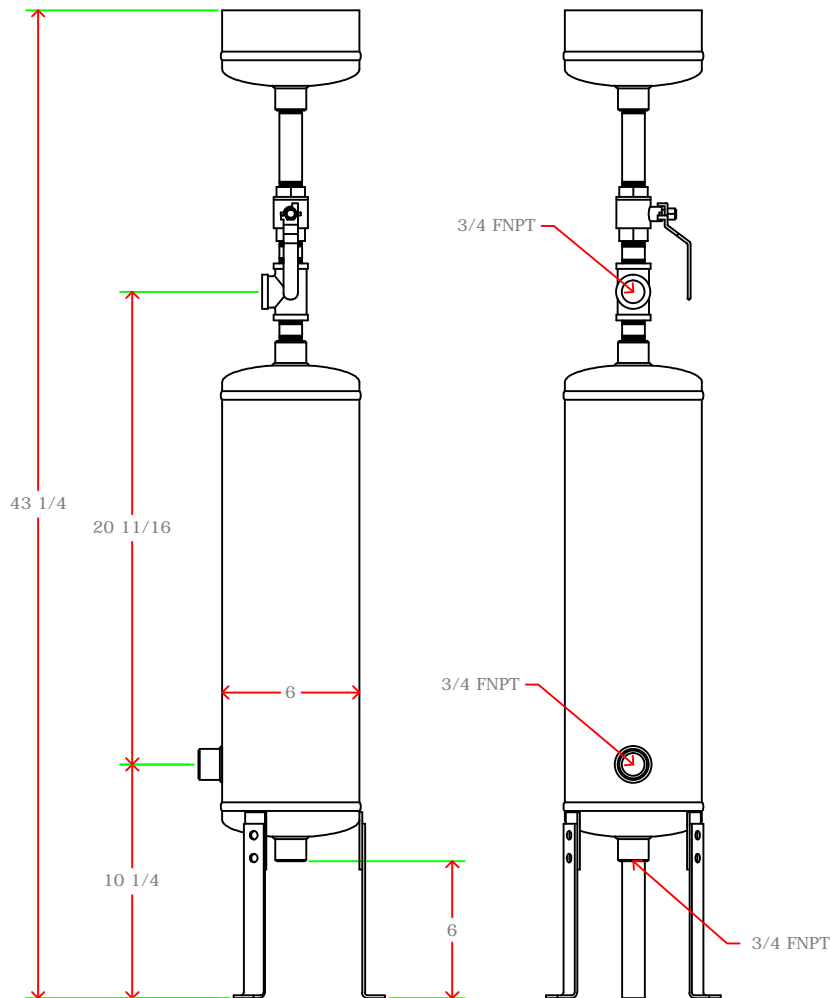
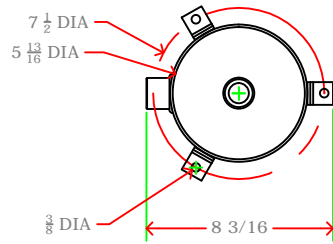

MATERIALS OF CONSTRUCTION:
CARBON STEEL, BRASS, DUCTILE IRON

Capacity: 2 Gallons
Max Temp.: 200 F
Max Press.: 300 PSI
Weight: 17 Lbs.

20	x	x
19	x	x
18	x	x
17	x	x
16	x	x
15	x	x
14	x	x
13	x	x
12	x	x
11	x	x
10	x	x
9	x	x
8	x	x
7	x	x
6	x	x
5	x	x
4	x	x
3	x	x
2	x	x
1	x	x

#	PART	DESCRIPTION
F	x	xx/xx/xx
E	x	xx/xx/xx
D	x	xx/xx/xx
C	x	xx/xx/xx
B	x	xx/xx/xx
REV	DESCRIPTION	DATE

General Treatment Products, Inc.
PO Box 8697, Brea, CA 92822
Phone: 714) 257-9165 <http://www.gtpcompany.com>
Fax: 714) 257-9215 customerservice@gtpcompany.com

Date: 1/1/12 Scale: NTS Rev.: A

Description:
2GL DOME BOTTOM BYPASS FEEDER

Model:
DB2/HP

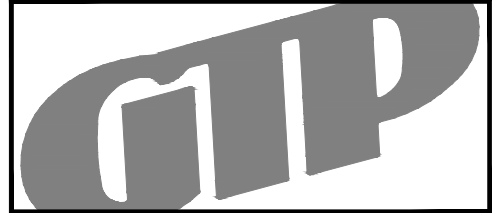
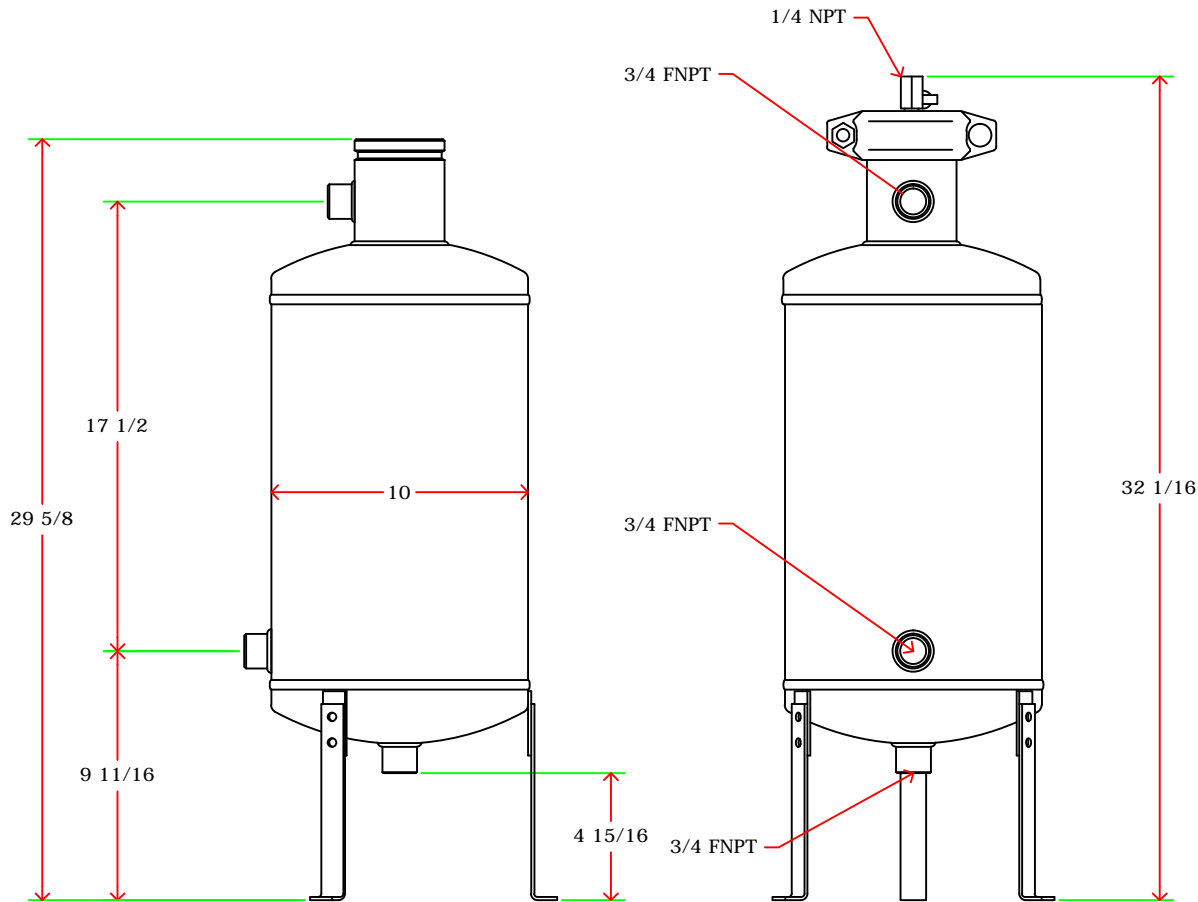
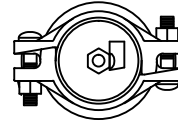
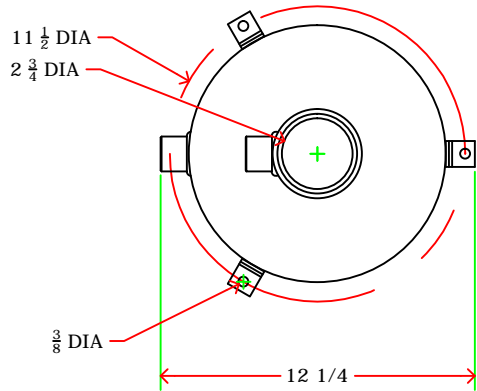

MATERIALS OF CONSTRUCTION:
CARBON STEEL, BRASS, DUCTILE IRON

Capacity: 5 Gallons
Max Temp.: 200 F
Max Press.: 300 PSI
Weight: 36 Lbs.

20	x	x
19	x	x
18	x	x
17	x	x
16	x	x
15	x	x
14	x	x
13	x	x
12	x	x
11	x	x
10	x	x
9	x	x
8	x	x
7	x	x
6	x	x
5	x	x
4	x	x
3	x	x
2	x	x
1	x	x

#	PART	DESCRIPTION
F	x	xx/xx/xx
E	x	xx/xx/xx
D	x	xx/xx/xx
C	x	xx/xx/xx
B	x	xx/xx/xx
REV	DESCRIPTION	DATE

General Treatment Products, Inc.
PO Box 8697, Brea, CA 92822
Phone: 714) 257-9165
Fax: 714) 257-9215
<http://www.gtpcompany.com>
customerservice@gtpcompany.com

Date: 1/1/12 Scale: NTS Rev.: A

Description:
5GL DOME BOTTOM BYPASS FEEDER

Model:
DB5

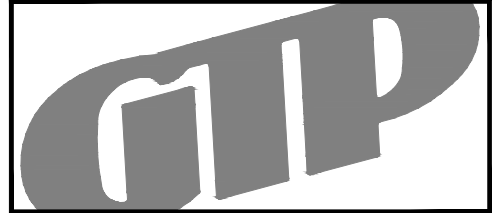
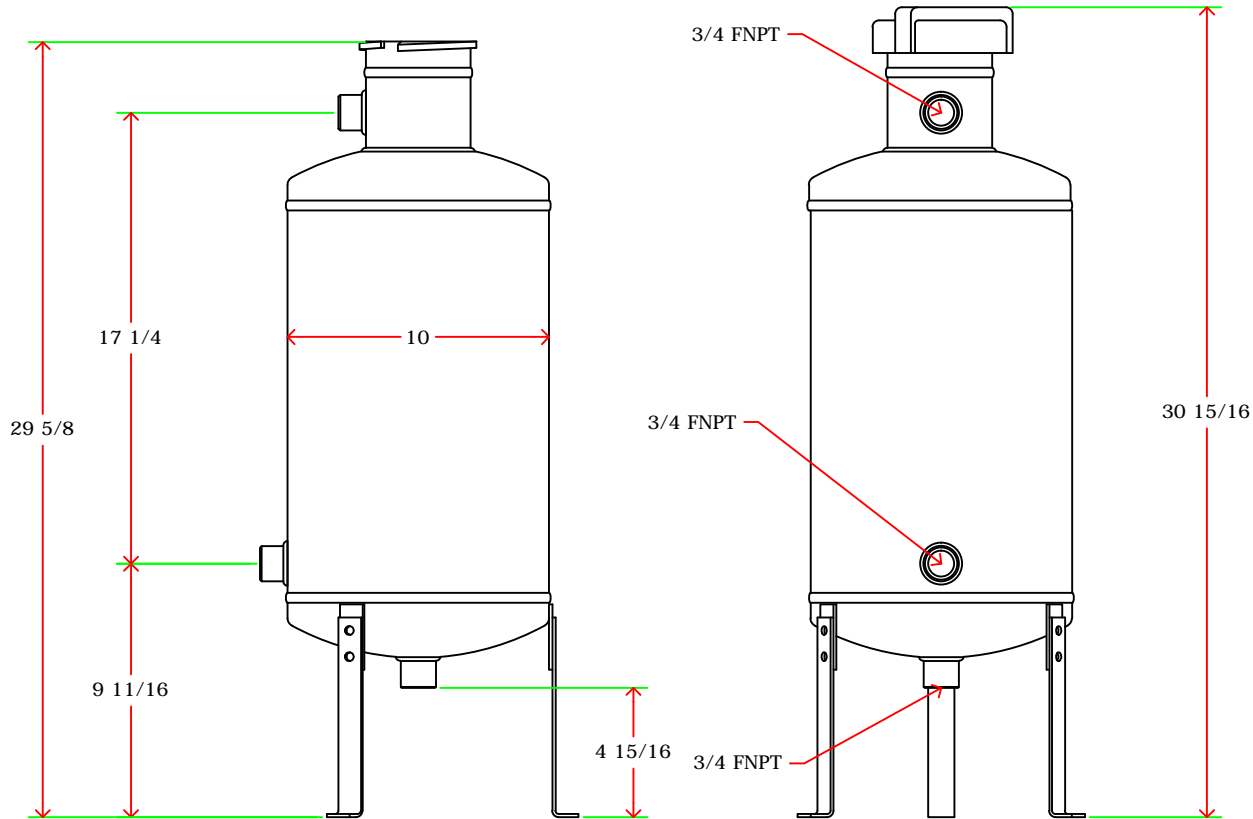
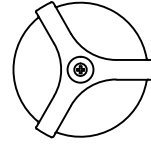
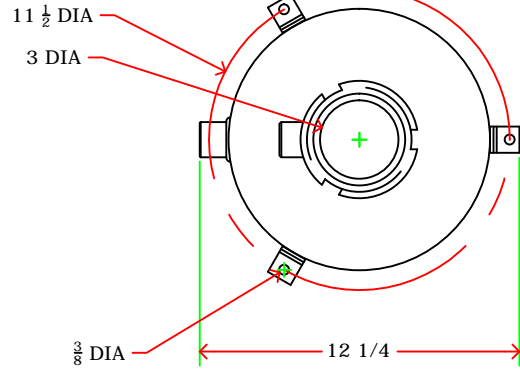

MATERIALS OF CONSTRUCTION:
CARBON STEEL, DUCTILE IRON

Capacity: 5 Gallons
Max Temp.: 200 F
Max Press.: 200 PSI
Weight: 36 Lbs.

20	x	x
19	x	x
18	x	x
17	x	x
16	x	x
15	x	x
14	x	x
13	x	x
12	x	x
11	x	x
10	x	x
9	x	x
8	x	x
7	x	x
6	x	x
5	x	x
4	x	x
3	x	x
2	x	x
1	x	x

#	PART	DESCRIPTION
F	x	xx/xx/xx
E	x	xx/xx/xx
D	x	xx/xx/xx
C	x	xx/xx/xx
B	x	xx/xx/xx
REV	DESCRIPTION	DATE

General Treatment Products, Inc.
PO Box 8697, Brea, CA 92822
Phone: 714) 257-9165 <http://www.gtpcompany.com>
Fax: 714) 257-9215 customerservice@gtpcompany.com

Date: 1/1/12 Scale: NTS Rev.: A

Description:
5GL DOME BOTTOM BYPASS FEEDER

Model:
DB5/QC

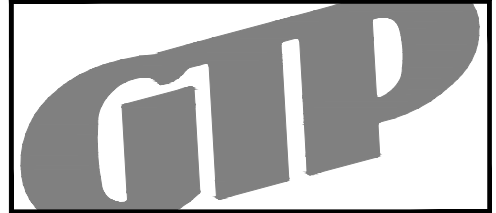
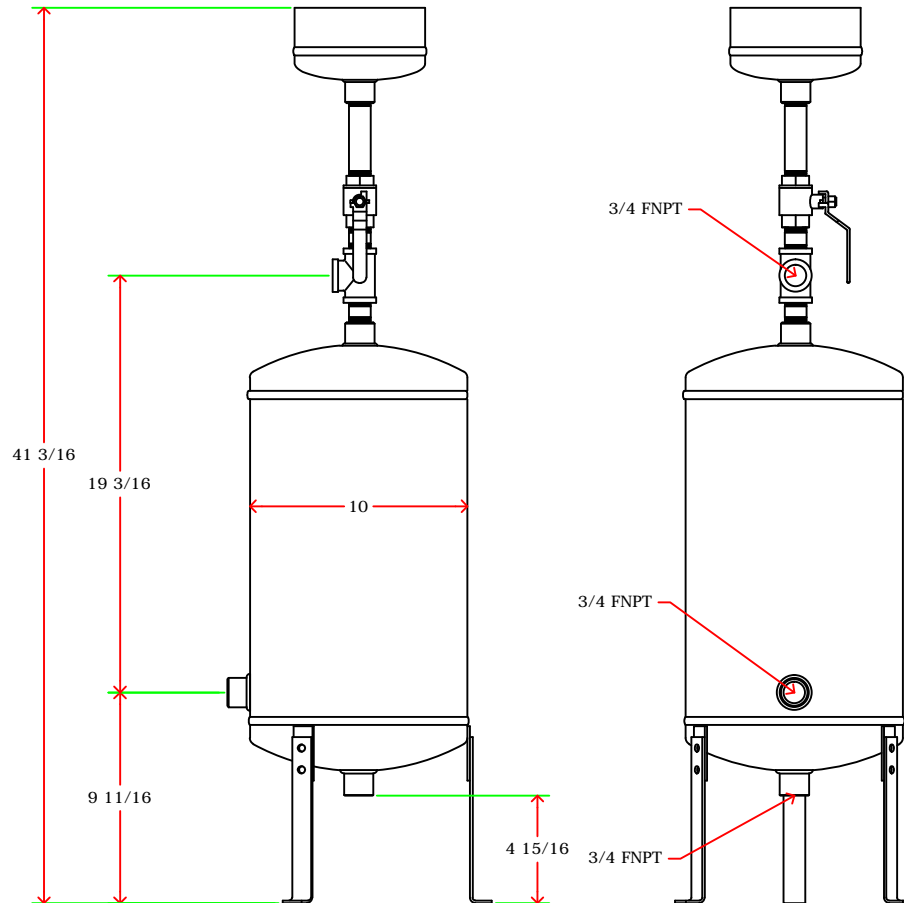
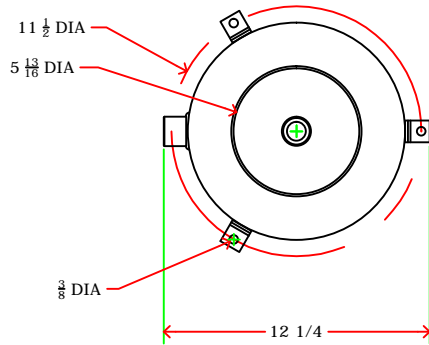

MATERIALS OF CONSTRUCTION:
CARBON STEEL, BRASS, DUCTILE IRON

Capacity: 5 Gallons
Max Temp.: 200 F
Max Press.: 300 PSI
Weight: 36 Lbs.

20	x	x
19	x	x
18	x	x
17	x	x
16	x	x
15	x	x
14	x	x
13	x	x
12	x	x
11	x	x
10	x	x
9	x	x
8	x	x
7	x	x
6	x	x
5	x	x
4	x	x
3	x	x
2	x	x
1	x	x

#	PART	DESCRIPTION
F	x	xx/xx/xx
E	x	xx/xx/xx
D	x	xx/xx/xx
C	x	xx/xx/xx
B	x	xx/xx/xx
REV	DESCRIPTION	DATE

General Treatment Products, Inc.
PO Box 8697, Brea, CA 92822
Phone: 714) 257-9165
Fax: 714) 257-9215
<http://www.gtpcompany.com>
customerservice@gtpcompany.com

Date: 1/1/12 Scale: NTS Rev.: A

Description:
5GL DOME BOTTOM BYPASS FEEDER

Model:
DB5/HP

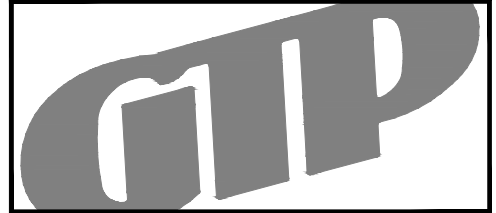
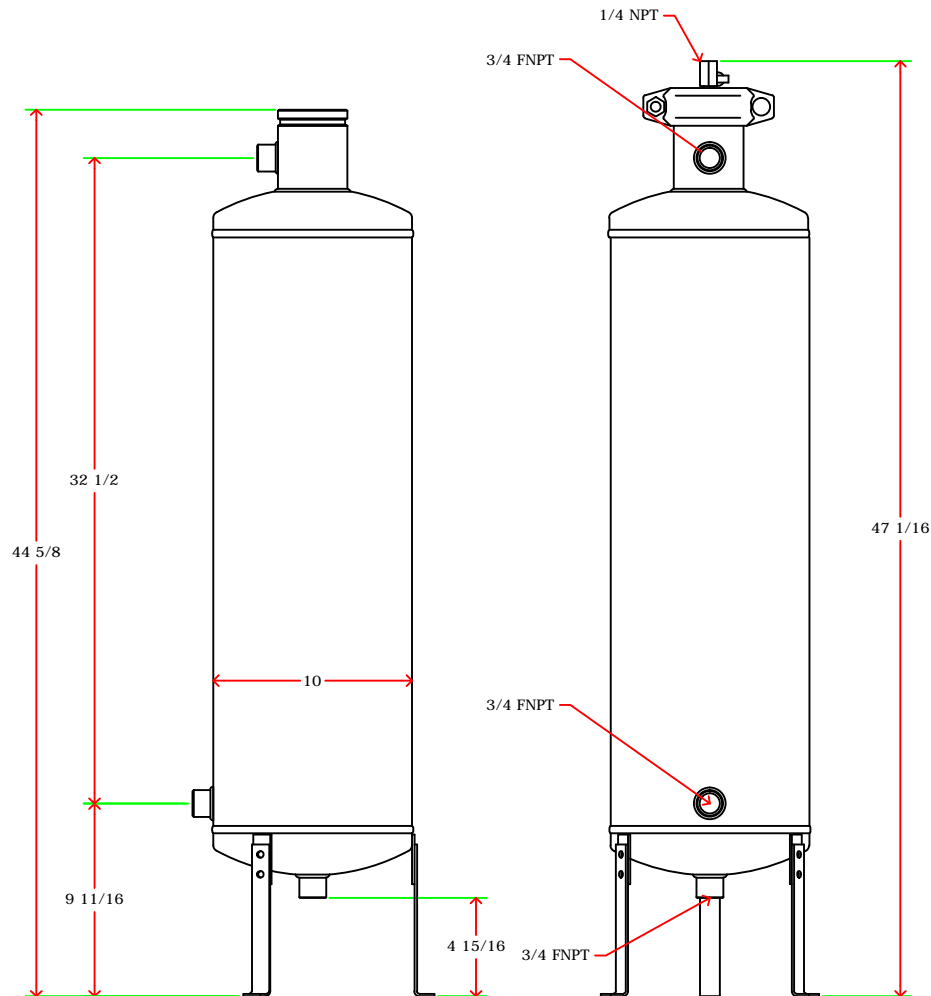
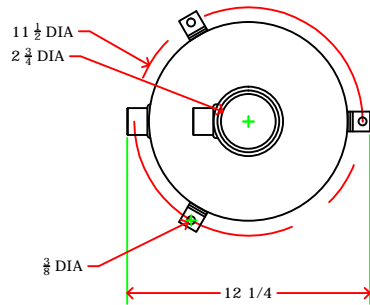

MATERIALS OF CONSTRUCTION:
CARBON STEEL, BRASS, DUCTILE IRON

Capacity: 10 Gallons
Max Temp.: 200 F
Max Press.: 300 PSI
Weight: 53 Lbs.

20	x	x
19	x	x
18	x	x
17	x	x
16	x	x
15	x	x
14	x	x
13	x	x
12	x	x
11	x	x
10	x	x
9	x	x
8	x	x
7	x	x
6	x	x
5	x	x
4	x	x
3	x	x
2	x	x
1	x	x

#	PART	DESCRIPTION
F	x	xx/xx/xx
E	x	xx/xx/xx
D	x	xx/xx/xx
C	x	xx/xx/xx
B	x	xx/xx/xx
REV	DESCRIPTION	DATE

General Treatment Products, Inc.
PO Box 8697, Brea, CA 92822
Phone: 714) 257-9165 <http://www.gtpcompany.com>
Fax: 714) 257-9215 customerservice@gtpcompany.com

Date: 1/1/12 Scale: NTS Rev.: A

Description:
10GL DOME BOTTOM BYPASS FEEDER

Model:
DB10

NOTICE: This drawing and its contents are for the specific use of GTP customers only. It is not to be duplicated or copied without expressed written consent of General Treatment Products, Inc. We reserve the right to modify this drawing without notice.

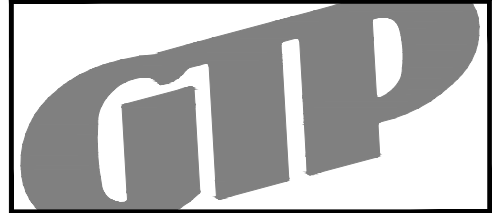
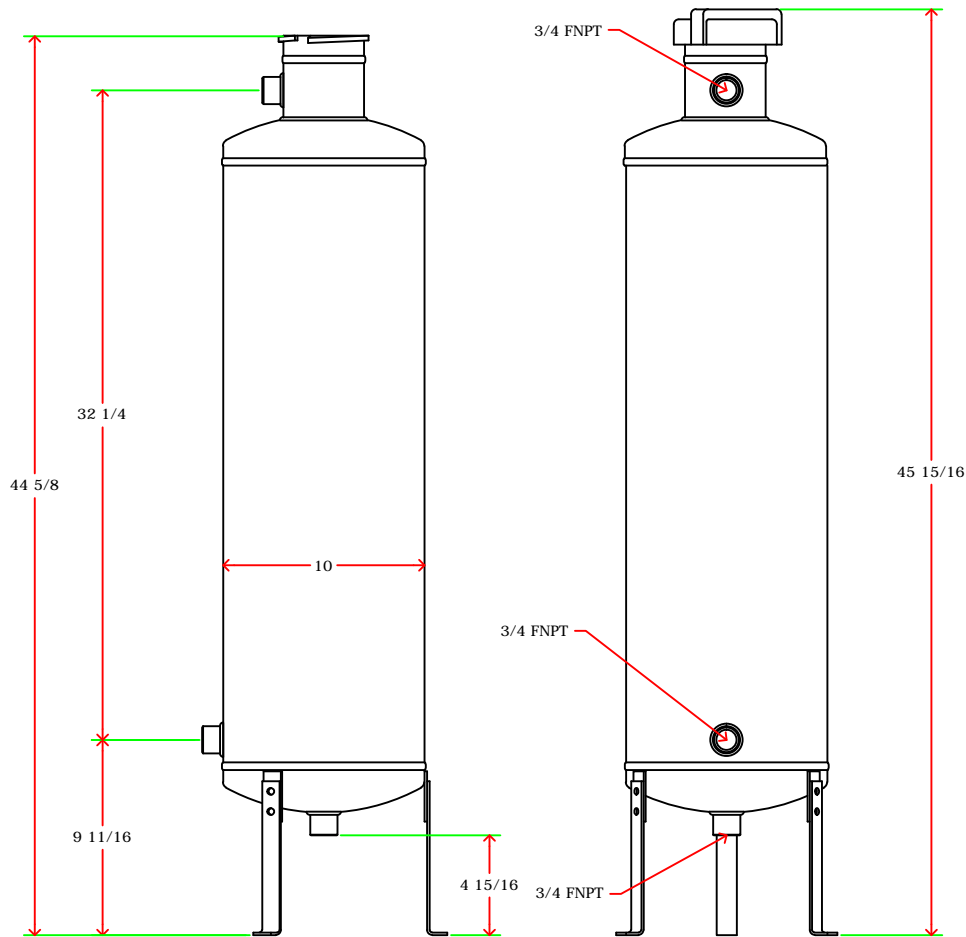
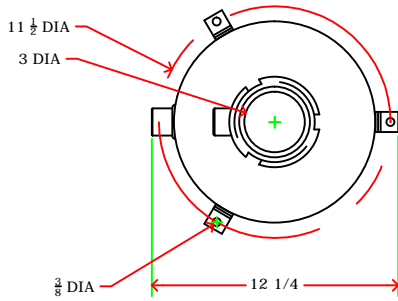

MATERIALS OF CONSTRUCTION:
CARBON STEEL, DUCTILE IRON

Capacity: 10 Gallons
Max Temp.: 200 F
Max Press.: 200 PSI
Weight: 53 Lbs.

20	x	x
19	x	x
18	x	x
17	x	x
16	x	x
15	x	x
14	x	x
13	x	x
12	x	x
11	x	x
10	x	x
9	x	x
8	x	x
7	x	x
6	x	x
5	x	x
4	x	x
3	x	x
2	x	x
1	x	x

#	PART	DESCRIPTION
F	x	xx/xx/xx
E	x	xx/xx/xx
D	x	xx/xx/xx
C	x	xx/xx/xx
B	x	xx/xx/xx
REV	DESCRIPTION	DATE

General Treatment Products, Inc.
PO Box 8697, Brea, CA 92822
Phone: 714) 257-9165 <http://www.gtpcompany.com>
Fax: 714) 257-9215 customerservice@gtpcompany.com

Date: 1/1/12 Scale: NTS Rev.: A

Description:
10GL DOME BOTTOM BYPASS FEEDER

Model:
DB10/QC

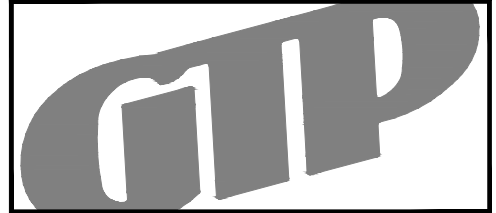
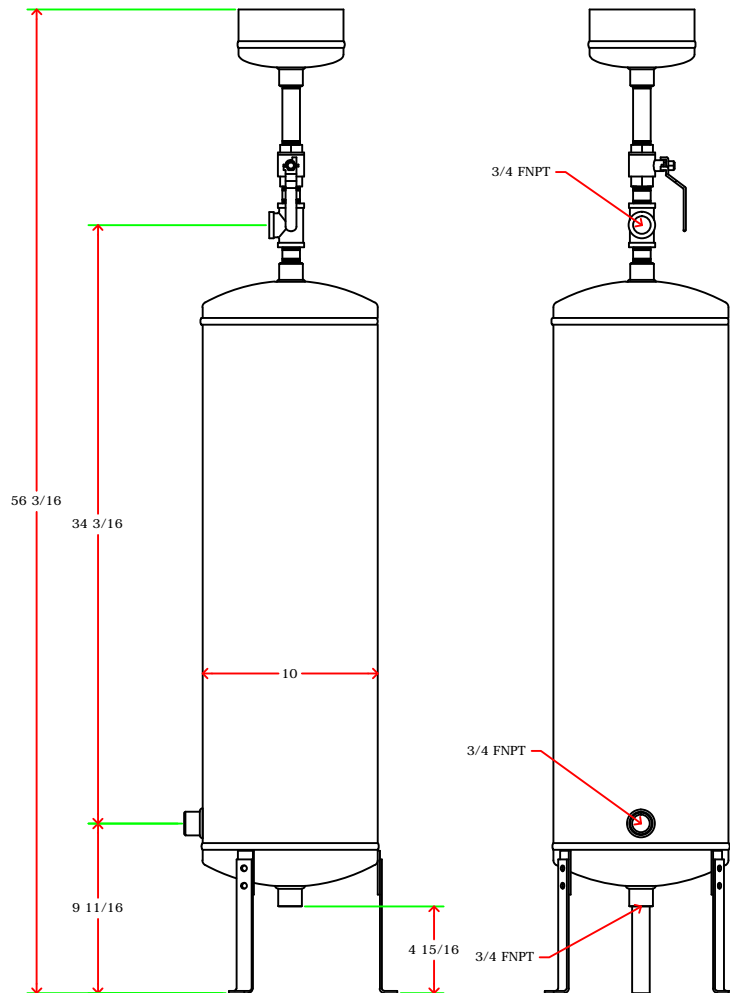
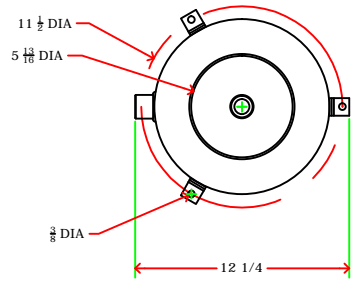

MATERIALS OF CONSTRUCTION:
CARBON STEEL, BRASS, DUCTILE IRON

Capacity: 10 Gallons
Max Temp.: 200 F
Max Press.: 300 PSI
Weight: 53 Lbs.

20	x	x
19	x	x
18	x	x
17	x	x
16	x	x
15	x	x
14	x	x
13	x	x
12	x	x
11	x	x
10	x	x
9	x	x
8	x	x
7	x	x
6	x	x
5	x	x
4	x	x
3	x	x
2	x	x
1	x	x

#	PART	DESCRIPTION
F	x	xx/xx/xx
E	x	xx/xx/xx
D	x	xx/xx/xx
C	x	xx/xx/xx
B	x	xx/xx/xx
REV	DESCRIPTION	DATE

General Treatment Products, Inc.
PO Box 8697, Brea, CA 92822
Phone: 714) 257-9165 <http://www.gtpcompany.com>
Fax: 714) 257-9215 customerservice@gtpcompany.com

Date: 1/1/12 Scale: NTS Rev.: A

Description:
10GL DOME BOTTOM BYPASS FEEDER

Model:
DB10/HP