

INDUSTRIAL GLYCOL FEED INSTALLATION

“CPE” NEMA 4 CONTROL PANEL



LOCKING HINGED CLEAR COVER

LOW LEVEL LED INDICATOR

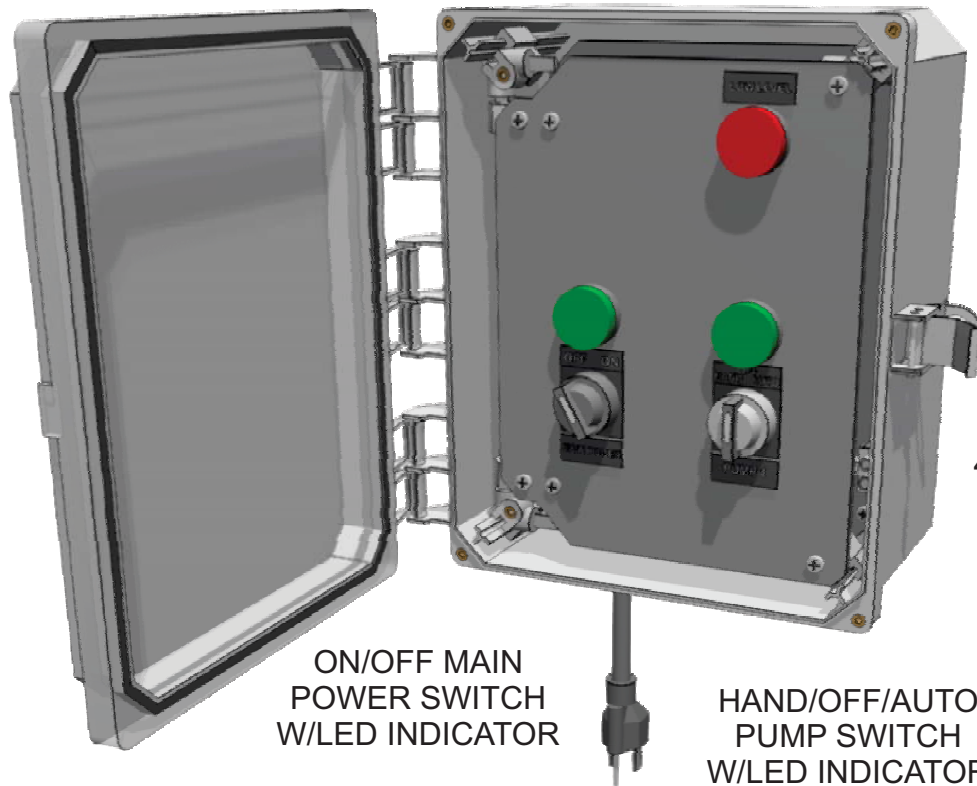

LOCKING NEMA 4 CONTROL PANEL W/CLEAR COVER

ON/OFF MAIN POWER SWITCH W/LED INDICATOR

HAND/OFF/AUTO PUMP SWITCH W/LED INDICATOR

MATERIALS OF CONSTRUCTION:
POLYCARBONATE

Capacity:	N/A	Gallons
Max Temp.:	85	F
Max Press.:	N/A	PSI
Weight:	10	Lbs.
Voltage.:	115 VAC	1 Phs 60 Hz
FLA.:	2	amps

20	x	x
19	x	x
18	x	x
17	x	x
16	x	x
15	x	x
14	x	x
13	x	x
12	x	x
11	x	x
10	x	x
9	x	x
8	x	x
7	x	x
6	x	x
5	x	x
4	x	x
3	x	x
2	x	x
1	x	x

REV	PART	DESCRIPTION
F	x	xxV/xxV
E	x	xxV/xxV
D	x	xxV/xxV
C	x	xxV/xxV
B	x	xxV/xxV

General Treatment Products, Inc.
 PO Box 8697, Brea, CA 92822
 Phone: 714) 257-9165 <http://www.gtpcompany.com>
 Fax: 714) 257-9215 customerservice@gtpcompany.com

Date: 1/1/2017 **Scale:** NTS **Rev.:** A

Description:
INDUSTRIAL GLYCOL FEED INSTALLATION

Model:
CPE